

1:10.000
↑N



1:1.000

Year 0 - Start construction island by raising sand ridges



1:10.000
↑N



1:1.000

Year 0 - 3 - Anchor the sandridges with stones and vegetation. Fill the area between the sandridges by spraying on excessive silt from the bottom of the IJmeer.



1:10.000
↑N

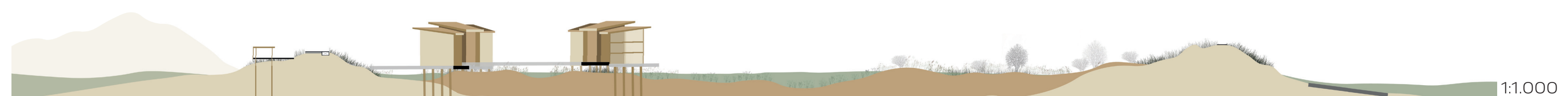

1:1.000

Year 5 - Plant diverse underwater plants, grasses and shrubs to start the first ecological processes by attracting insects, birds and fishes.



1:10.000
↑N



1:1.000

Year 7 - 8 - Plant the first trees close to each other according to the miyawaki reforestation method. To create a self sustaining forest ecosystem within 10 years.

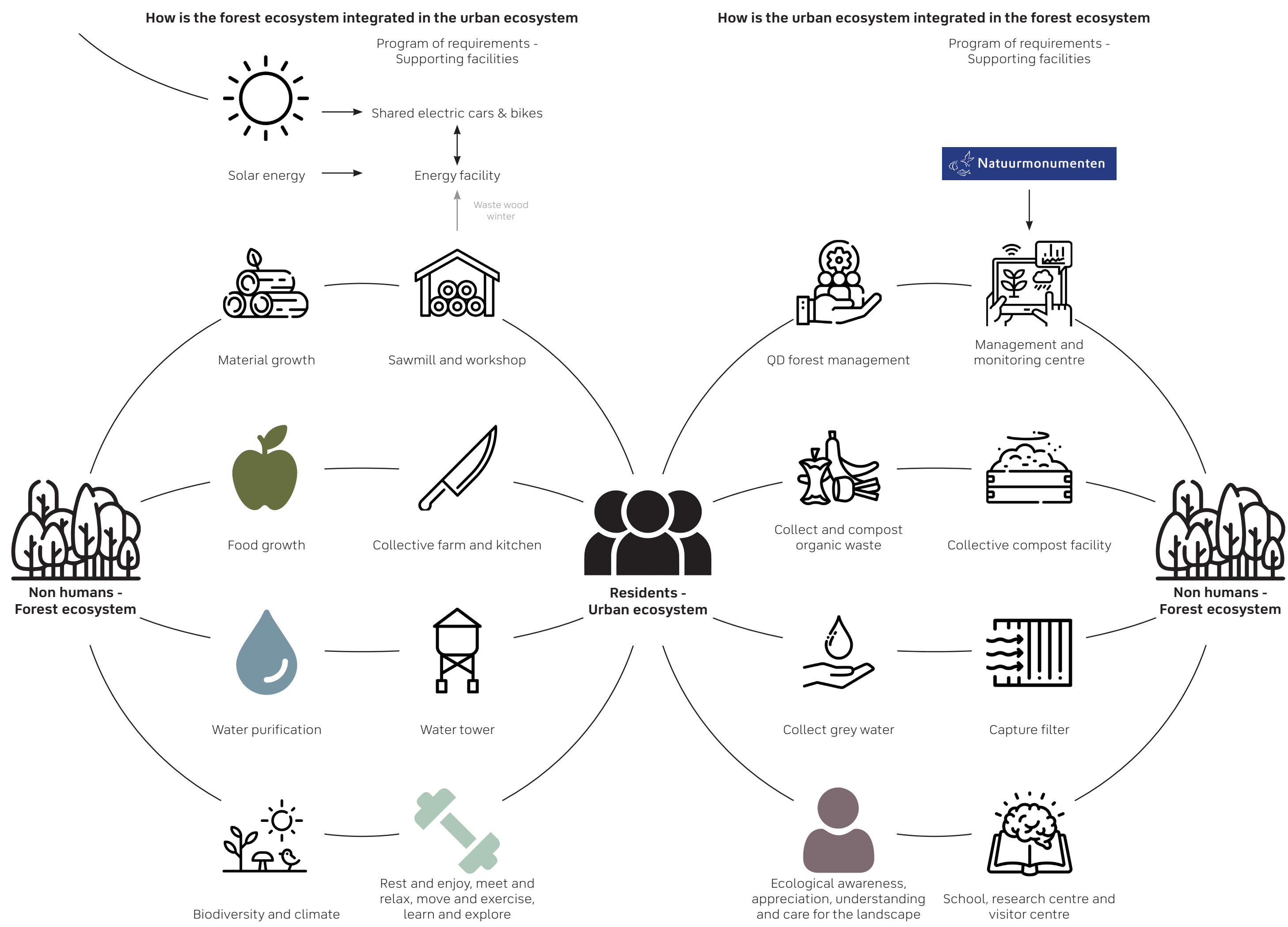
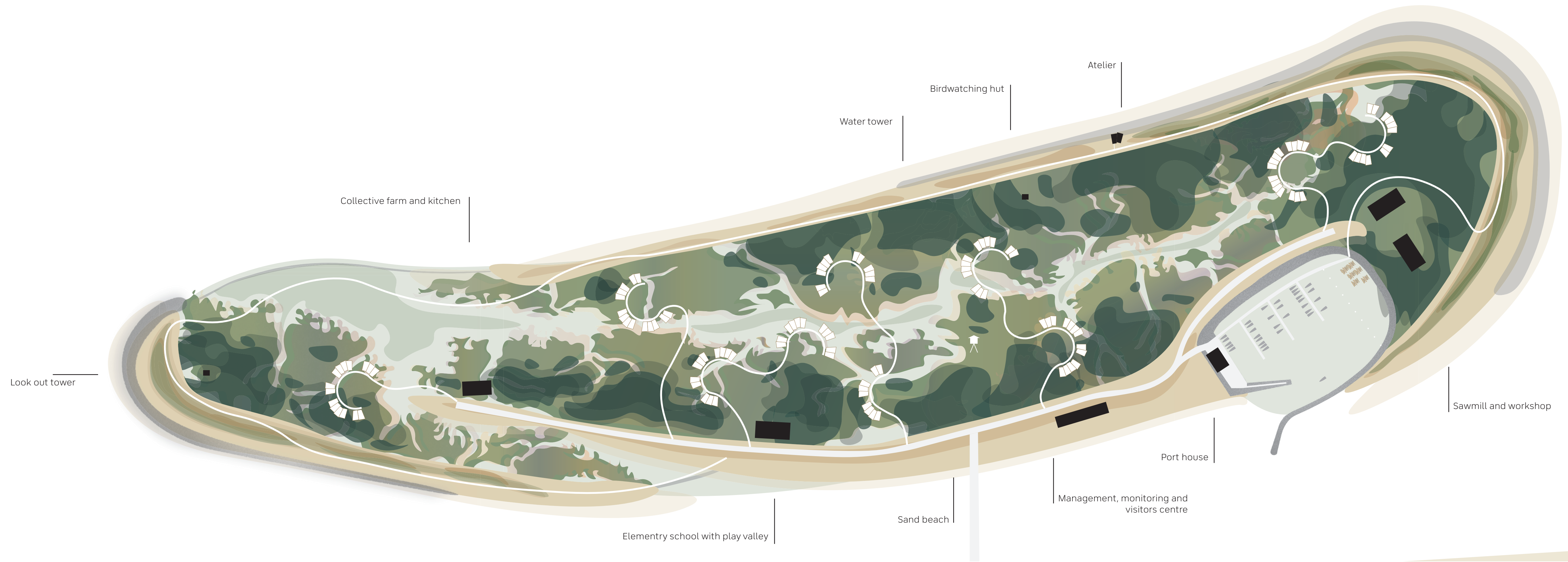



Black Alder (Zwarte Els) - *Alnus glutinosa*

Birch (Berk) - *Betula pendula* Roth

Black Poplar (Zwarte Populier) - *Populus nigra* L.

Oak (Eik) - *Quercus petraea*

Elm (Iep) - *Ulmus glabra*

Ash (Es) - *Fraxinus excelsior*

Willow (Wilg) - *Salix alba* L.

1:500

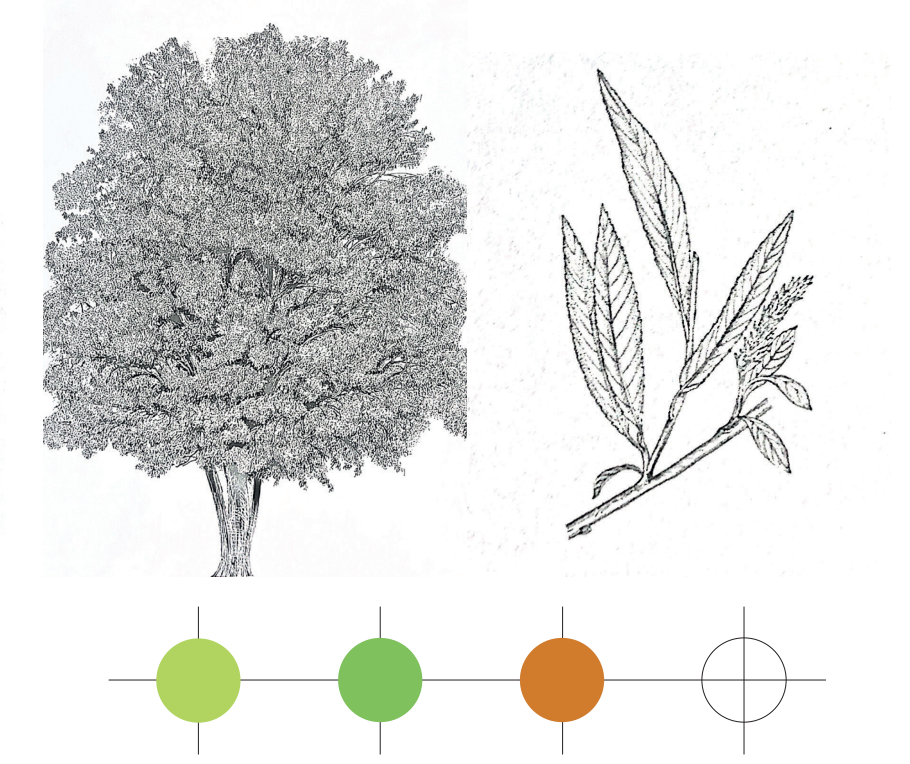
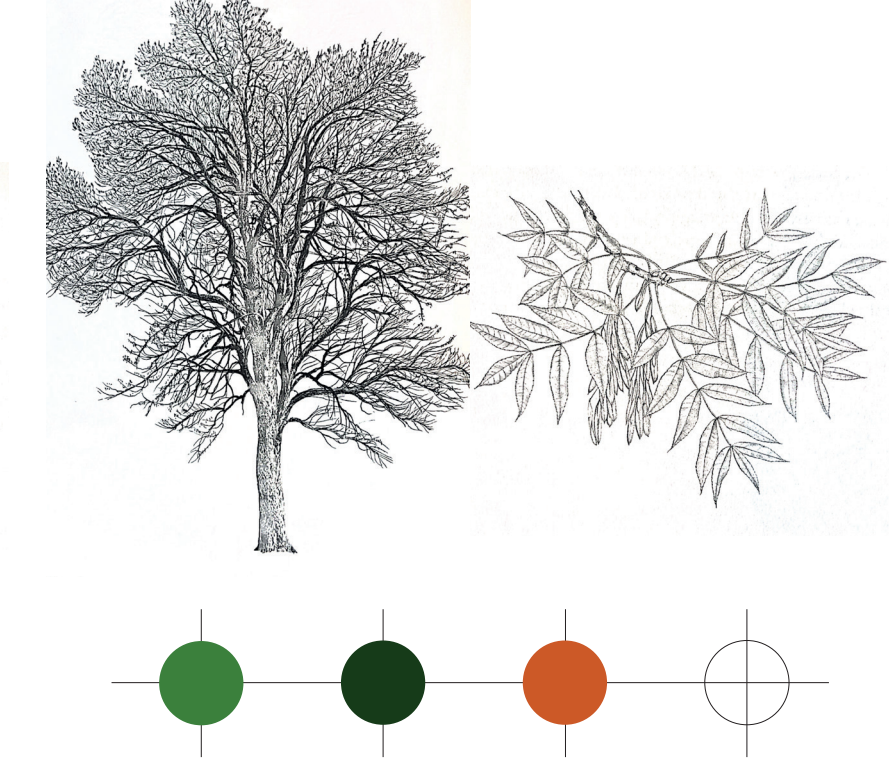
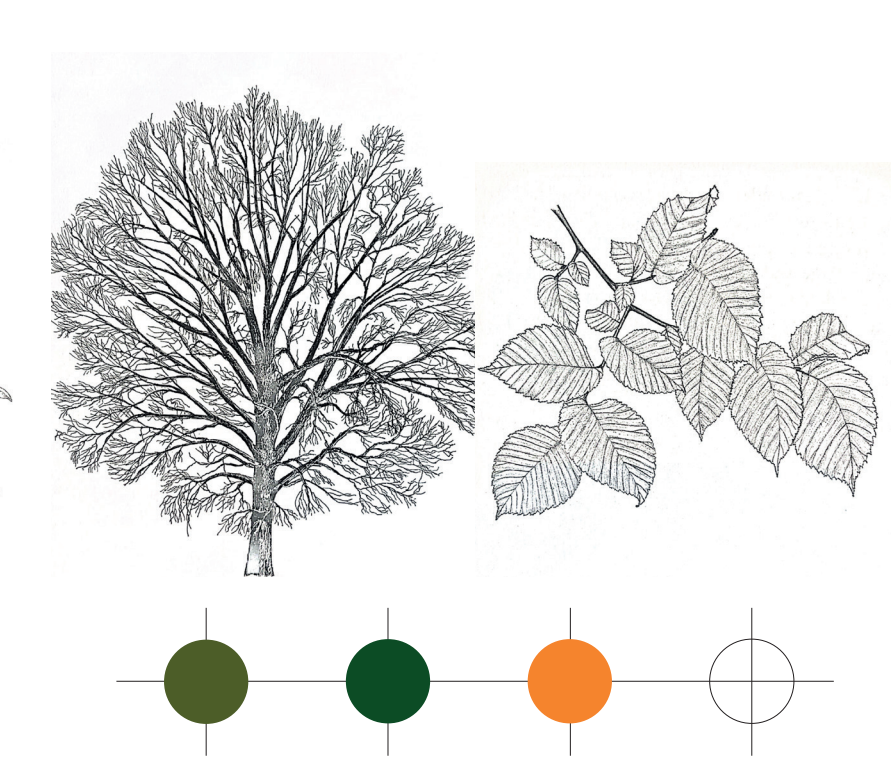
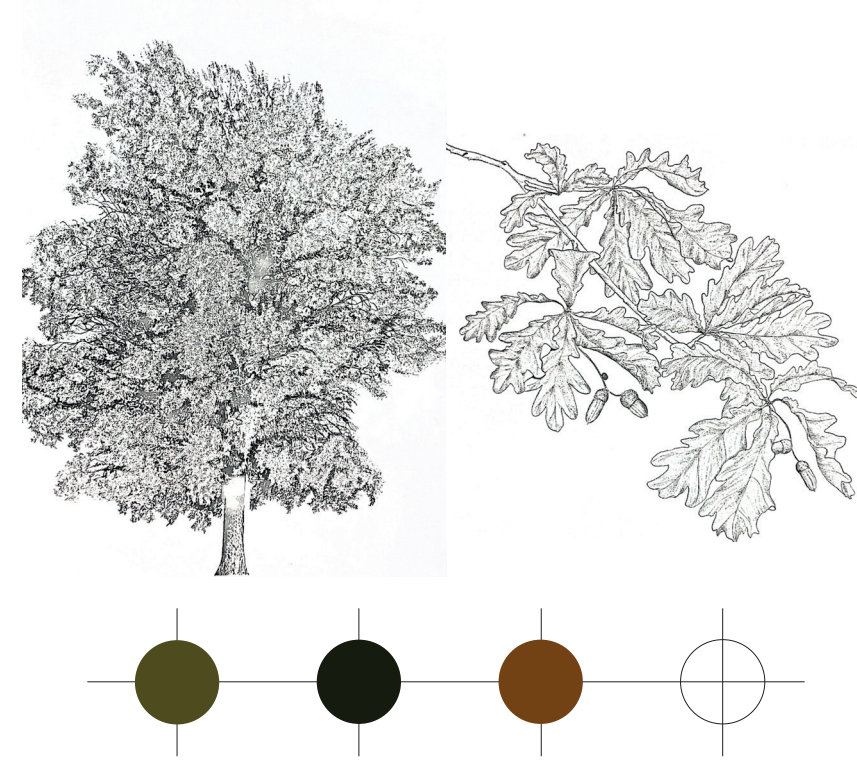
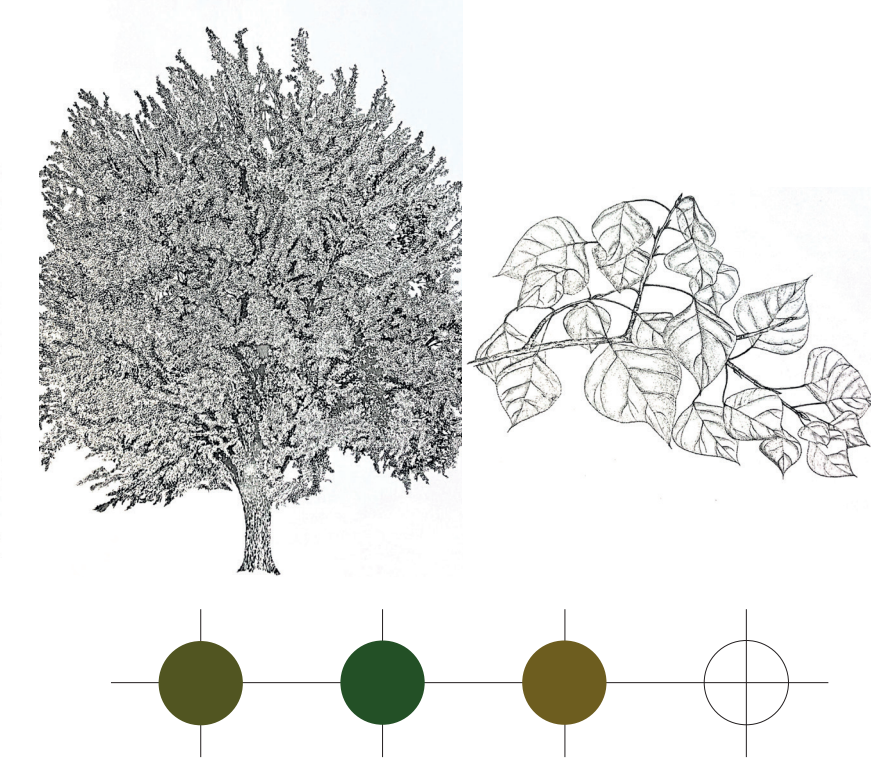
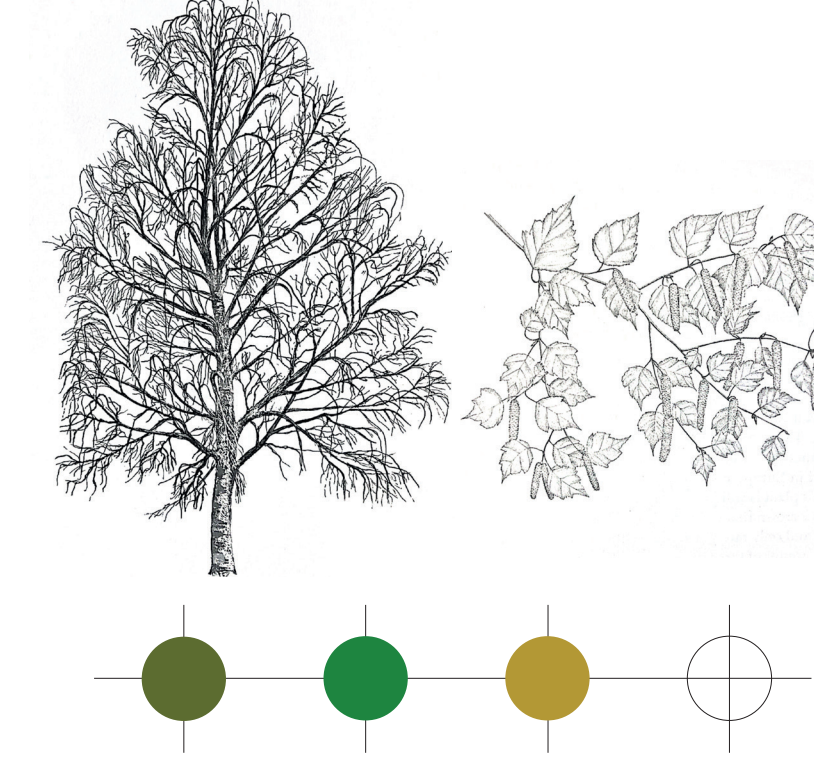
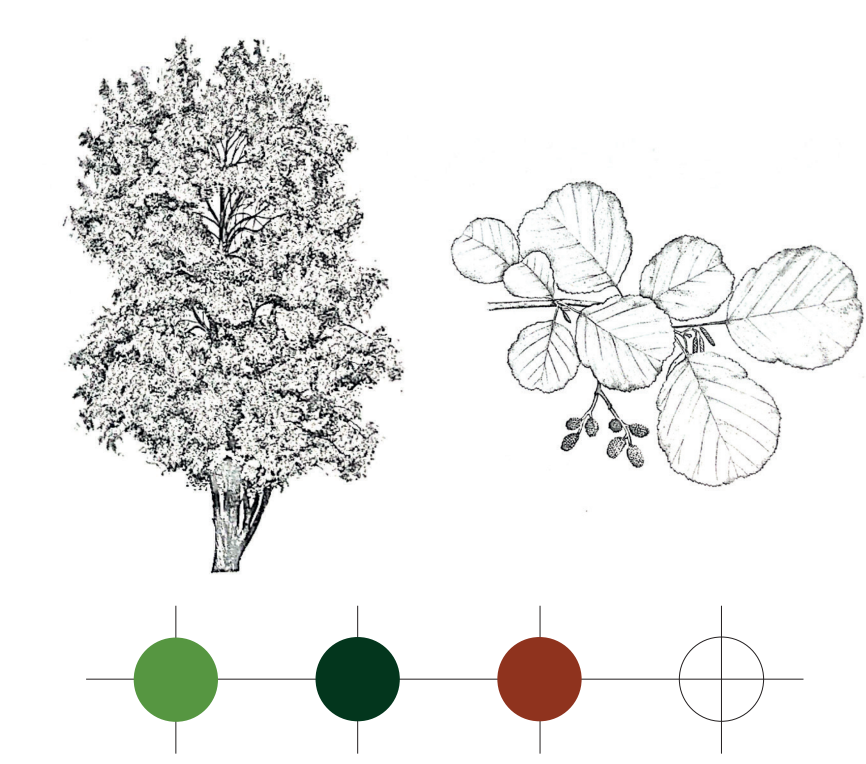

Alder timber

Birch timber

Poplar timber

Oak timber

Elm timber

Ash timber

Willow timber

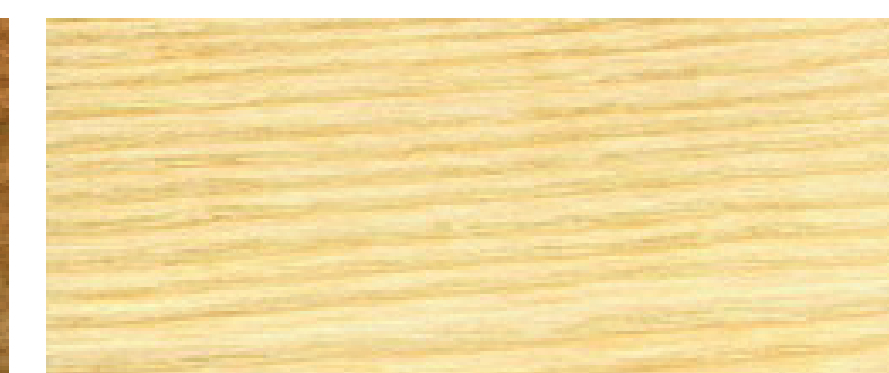
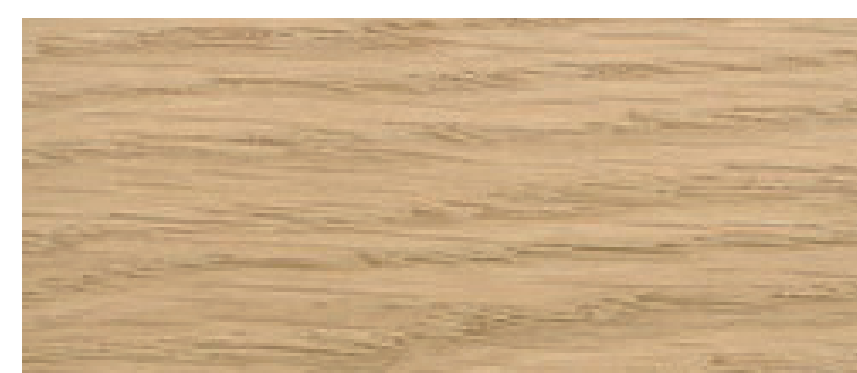
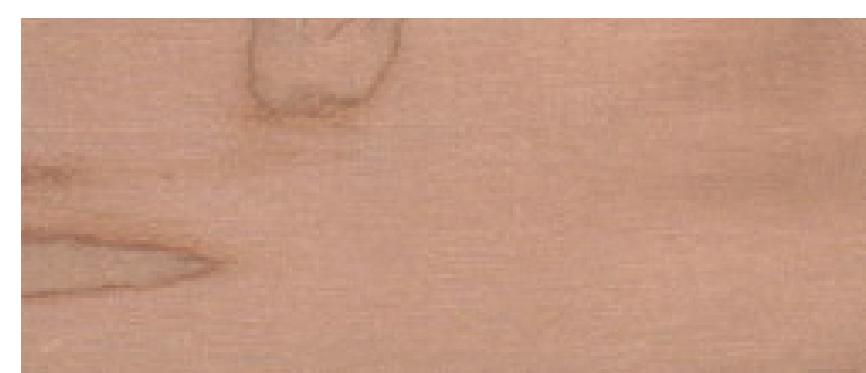



The dancing floors create different positions and views in relation to the landscape 1:100



Interior impression of a wetland dwelling overlooking the sandy plain landscape



The flexibly useable rooms enable creating different spatial conditions and views
↑ N 1:100

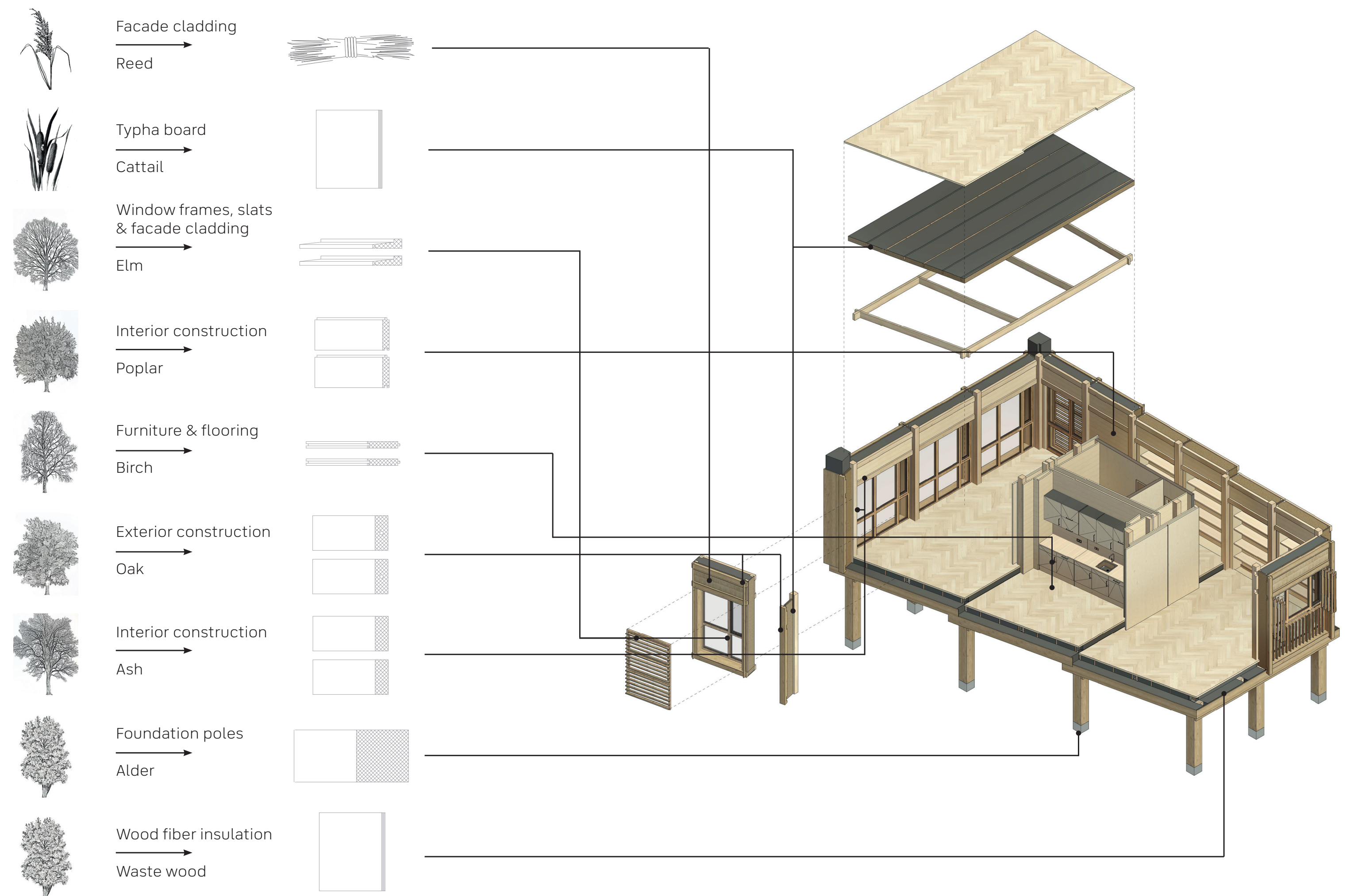

Facade fragment forest dwelling 1:25

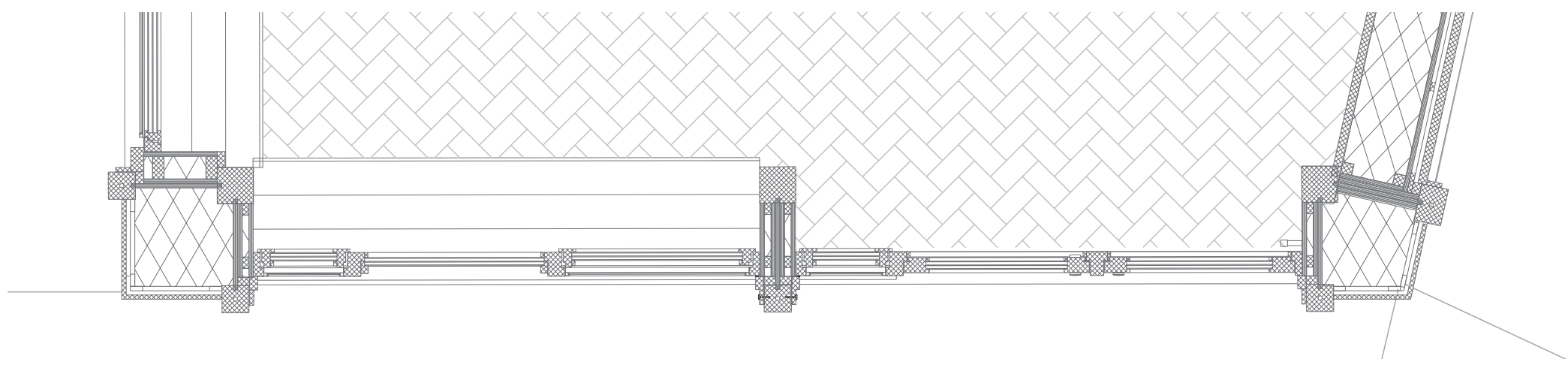

Facade fragment wetland dwelling 1:25

