

P2 PRESENTATION

A HOME TO REMEMBER

design for people with dementia

Kim Houweling | 5090342
23 January 2024

PROBLEM

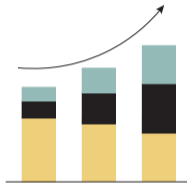

Aging and double aging population causing an increase of people with dementia

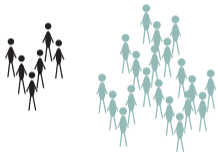

Growing imbalance between people who need care and people who can provide care



No sufficient and supportive living arrangements for people with dementia

Which living environment features provide people with dementia with quality of life and the care they need?

1. What architectural features in the **dwelling** can contribute to the quality of life for people with dementia?
2. What architectural features in the **building** can contribute to the quality of life for people with dementia?
3. What architectural features in the near **surroundings** can contribute to the quality of life for people with dementia?
4. What architectural features contribute to providing **care** for people with dementia?

THEMES

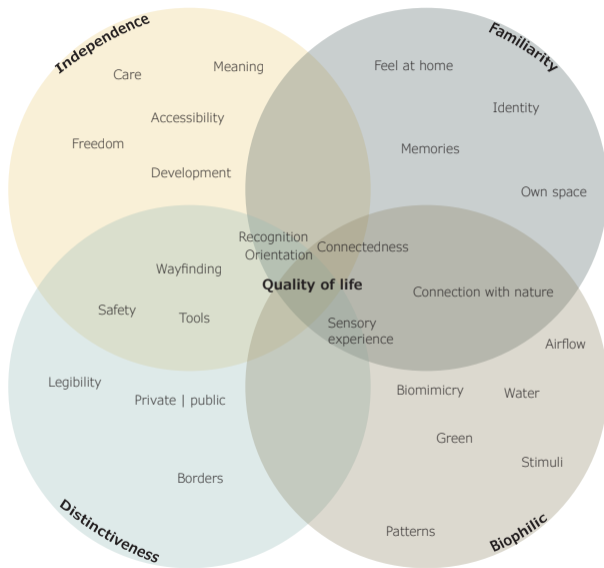

METHODS

Literature | Case studies | Fieldwork

Distinctiveness

Familiarity

Independence

Biophilic

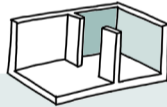

Visual link between rooms.
Changing facade color for each section

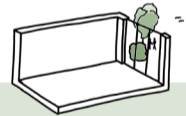

View on (changing) nature outside,
activity and people

BUILDING

Distinctiveness



Familiarity



Independence

Biophilic

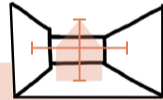

The spaces should be domestically scaled, avoid a clinical look, make it more home like in color and lighting

SURROUNDINGS

Distinctiveness

Familiarity

Independence

Biophilic

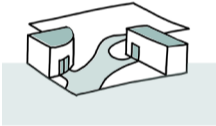

Freedom of movement

Care perspective



Short distances between apartments and activities. Practical shape of building that limits walking distance

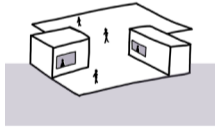

Visual connection between staff inside and inhabitants outside

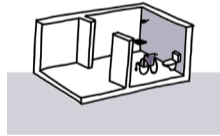

Dimensions suitable for people with wheelchair/stroller. Large enough spaces to provide help

SITE CRITERIA

1

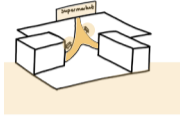

Supermarket and other facilities on walking distance

2

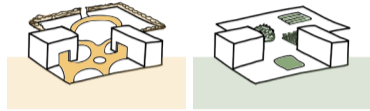

Enough space to provide freedom of movement, natural fence, and design outdoor space

3

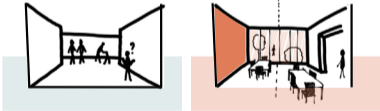

Interesting location for different target groups,
Central location in neighbourhood

4

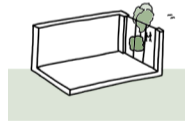

View on nature, activity and people from apartment

SITE





Tanthof East
Delft
The Netherlands

POSITION

1 Freedom of movement

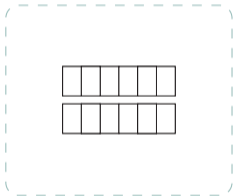

x



✓

2 People with all stages of dementia among elderly, age in place



x



✓

DWELLING

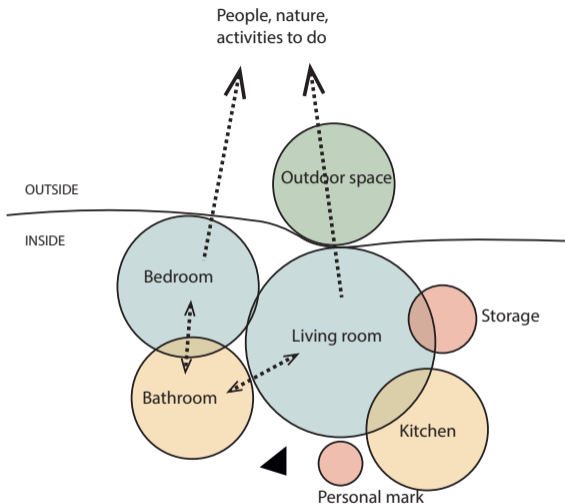
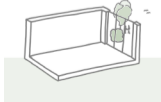
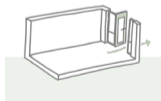
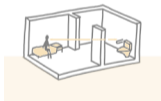
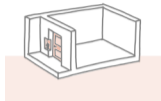
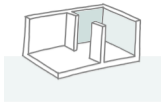

8/10 Single apartments
2/10 Couple apartments

ca. 40 m²
ca. 60 m²

BUILDING

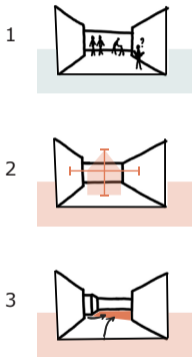

'Home'
non-institutional

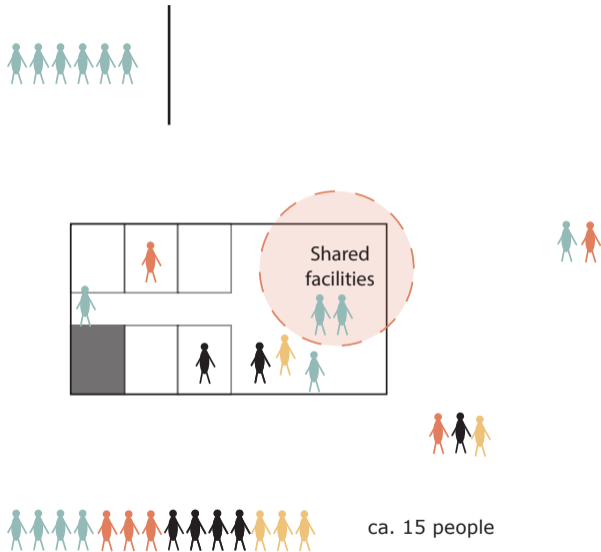

BUILDING

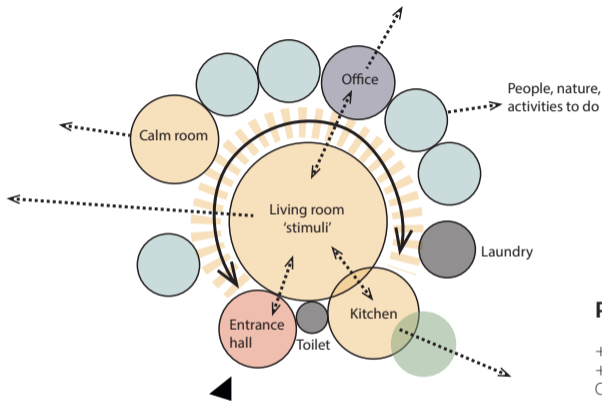
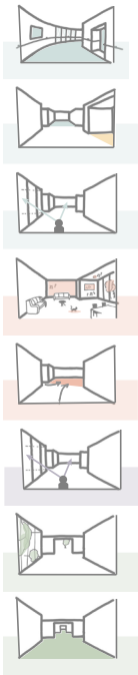

Program of requirements

+ - 10 single apartments	40 m ²
+ - 2 Couple apartments	60 m ²
Collective living room	50 m ²
Collective kitchen+ outside	30 m ²
Calm living room/nature	30 m ²
Storage	10 m ²
Activity hallway	20 m ²
Office	25 m ²
Laundry	10 m ²
Toilets	8 m ²

One building has larger office for meetings

BUILDING

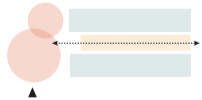
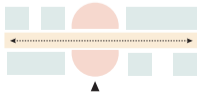
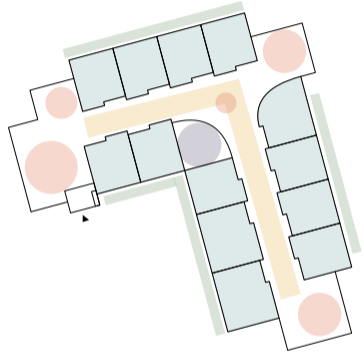
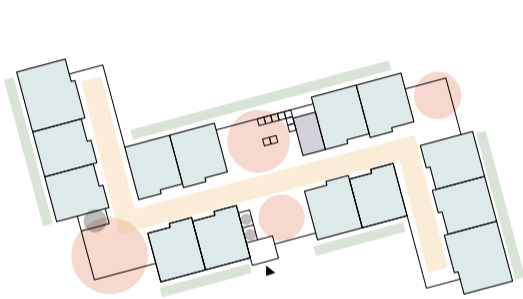
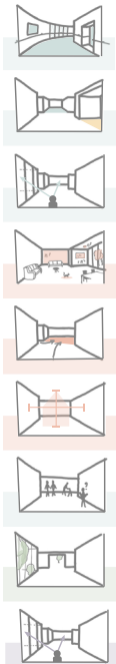

BUILDING

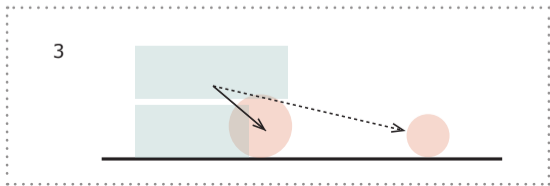
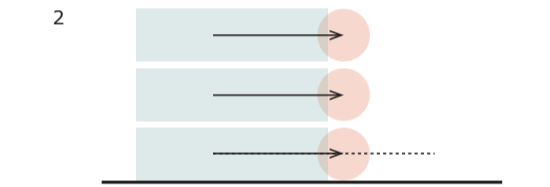
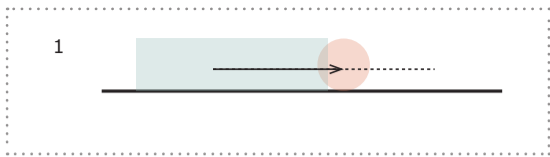

SURROUNDINGS

Program of requirements

- Benches
- Green/flowers/animals
- Pathways
- Shared
 - Multi-functional room (music, church, lecture, evening) ca. 100 m²
- Public
 - Café/lunchroom ca. 150 m²

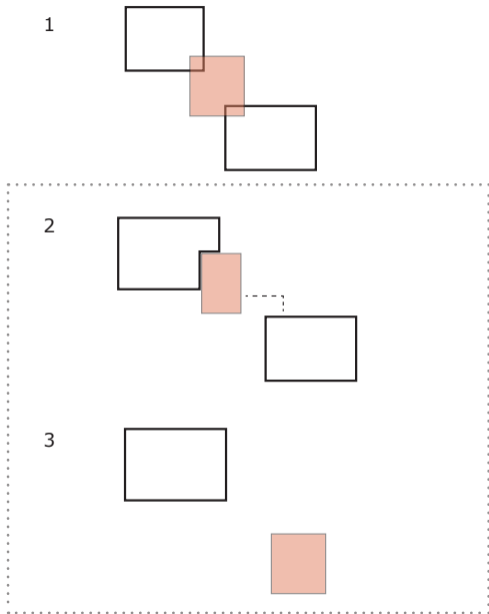

A

+ - 45 persons
Clear centre for activity
All apartments ground floor
Different buildings - recognizable
Visual links

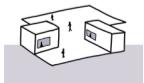
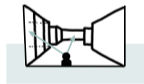

ON SITE

B

+ - 60 persons
Clear centre for activity
Two storey buildings
All buildings same shape
Safe cluster with option to go out
Visual links
Blind spots

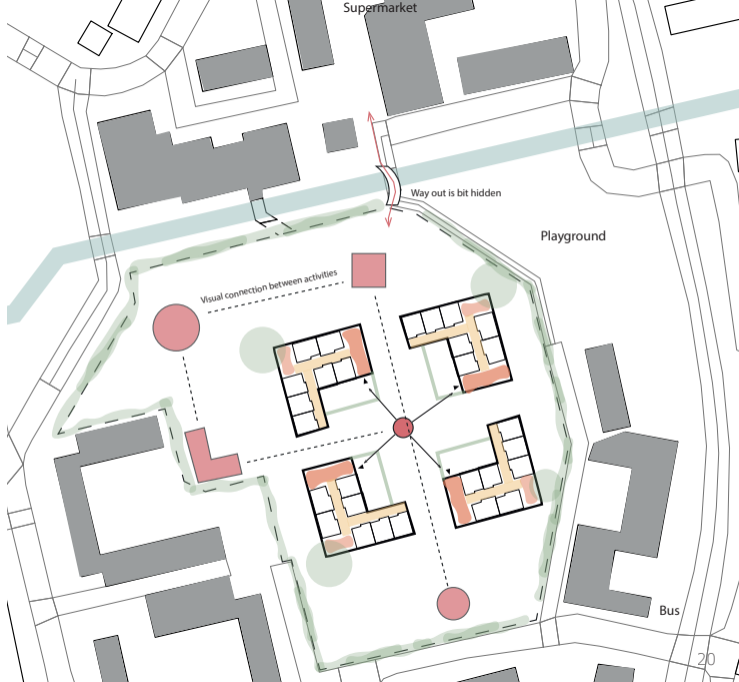
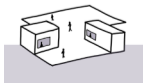
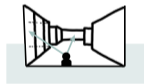



+ - 60 persons
Clear centre for activity
Ground floor and two storey buildings
Recognizable building
Visual links

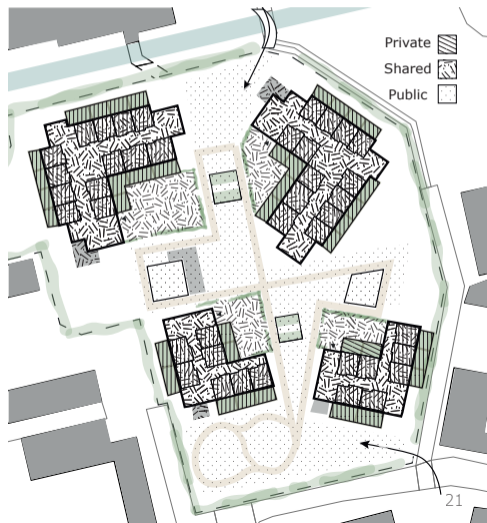

NEXT STEPS

- Integrate more guidelines in current development
- Explore more options
- More in detail; dwelling, building, surroundings

P2 PRESENTATION

A HOME TO REMEMBER

design for people with dementia



Kim Houweling | 5090342
23 January 2024