

identity ^{urban} أزمة
العمرانية ^{العمرانية} in crisis
REDEFINING VERNACULAR ARCHITECTURE IN CAIRO

an investigation into Cairo's built environment,
public space and spatial practices

تحقيق في البيئة العمرانية في القاهرة، والاماكن العامة
والممارسات\الانشطة المكانية

Nada Gemiei

URBAN IDENTITIES IN CRISIS

Redefining Vernacular Architecture in Cairo

Nada Gemiei

5541473

Graduation Studio: ExploreLab 2023-2024

Research Tutor: John Hanna

Design Tutor: Suzana Milinovic

Building Technology Tutor: Georgios Karvelas

MSc. Architecture

Faculty of Architecture and the Built Environment

Delft University of Technology



EXHIBITION

as presentation

In addition to a digital presentation, the P5 was presented as an exhibition that sheds light on all of the phases of the project and transports the viewer into the mind of the architect, highlighting not only the products of the research, design and building technology but the process which is integral to exploring the experimental and incremental nature of the position on vernacular architecture as spatial practices. Viewers are able to move around the room to engage with printed media in the form of booklets, sketches, posters, drawings and various scale models that explore the relationship between people and the built environment on the architectural as well as the intimate individual and larger urban scales.





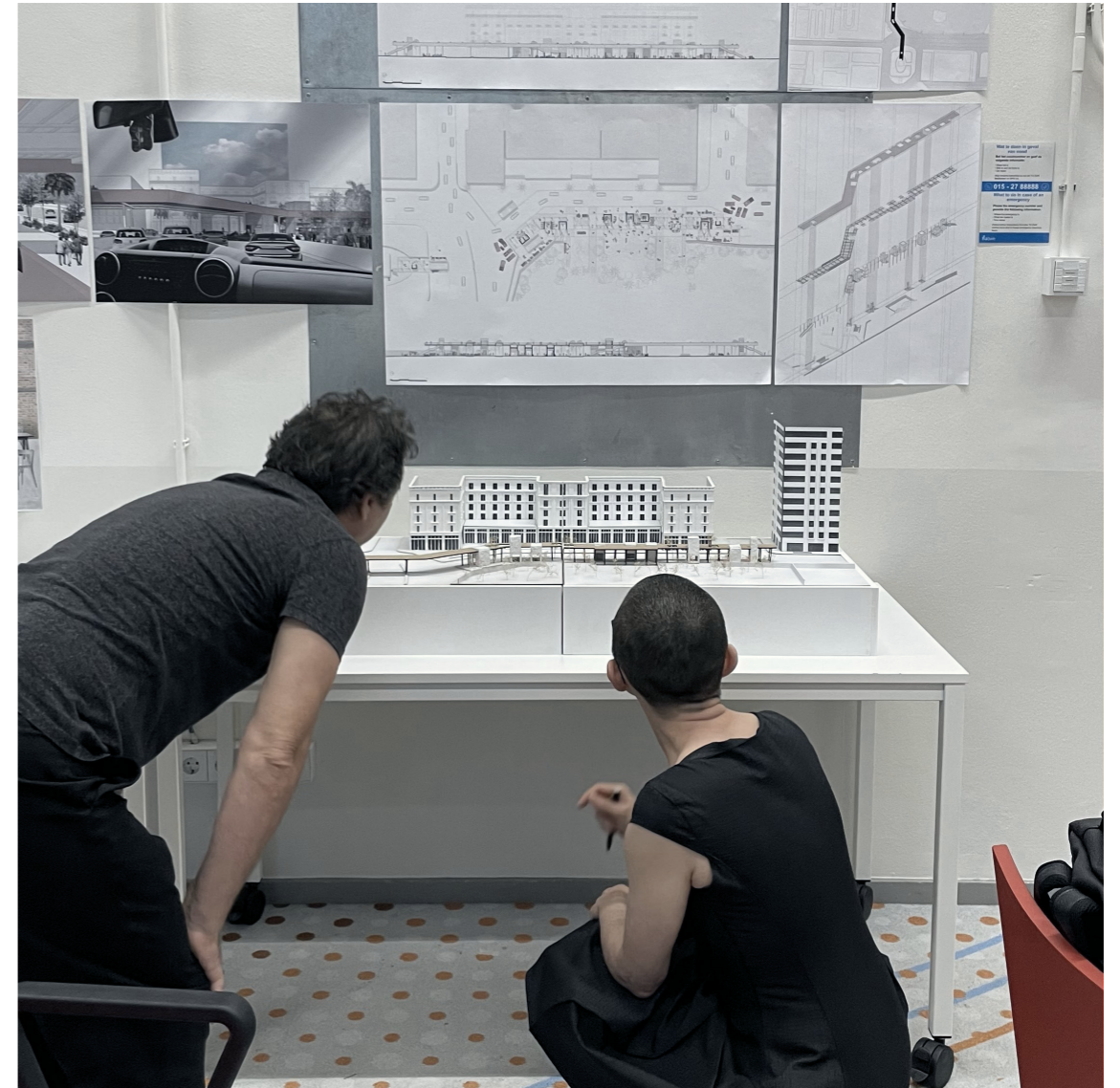
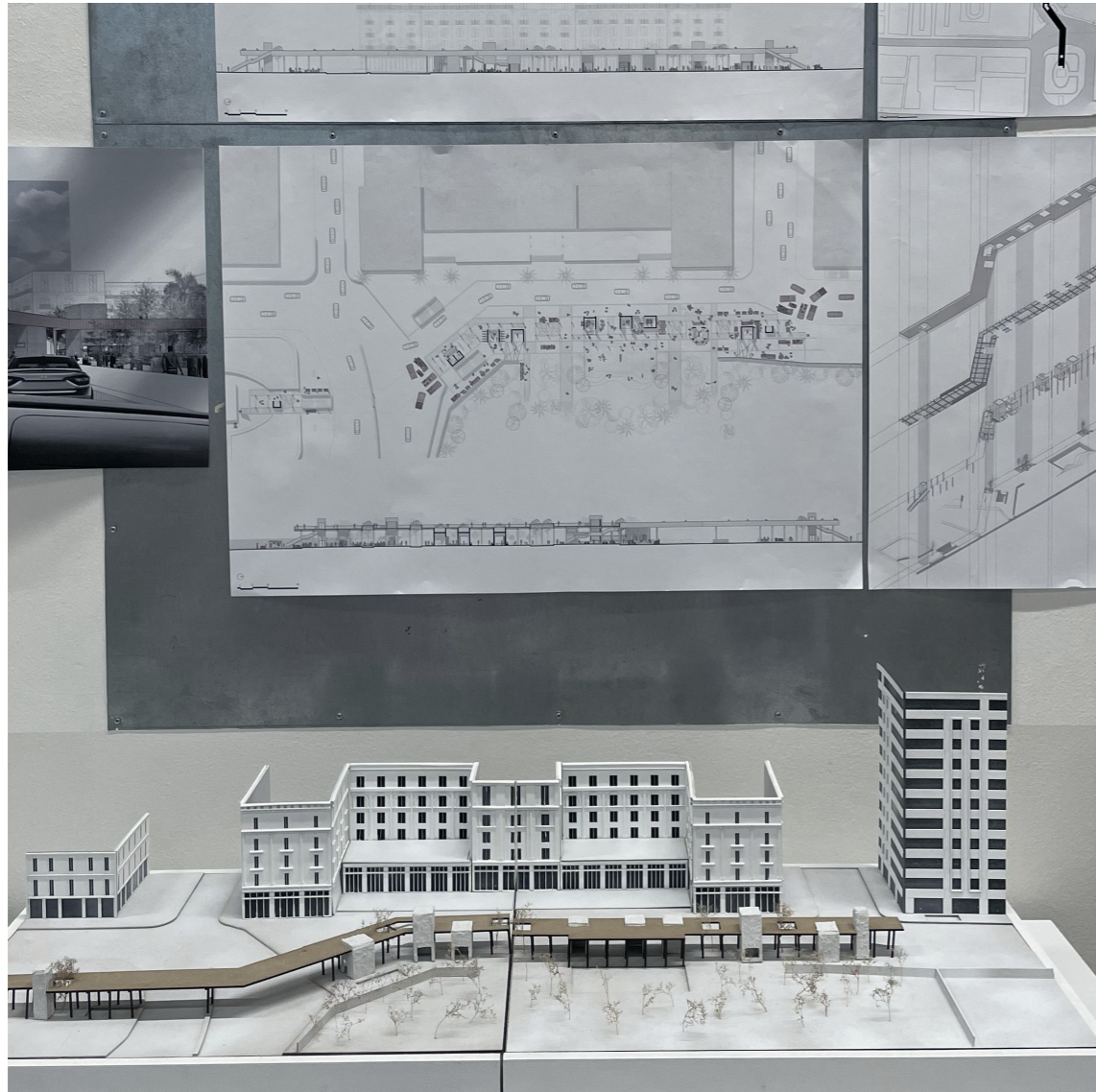



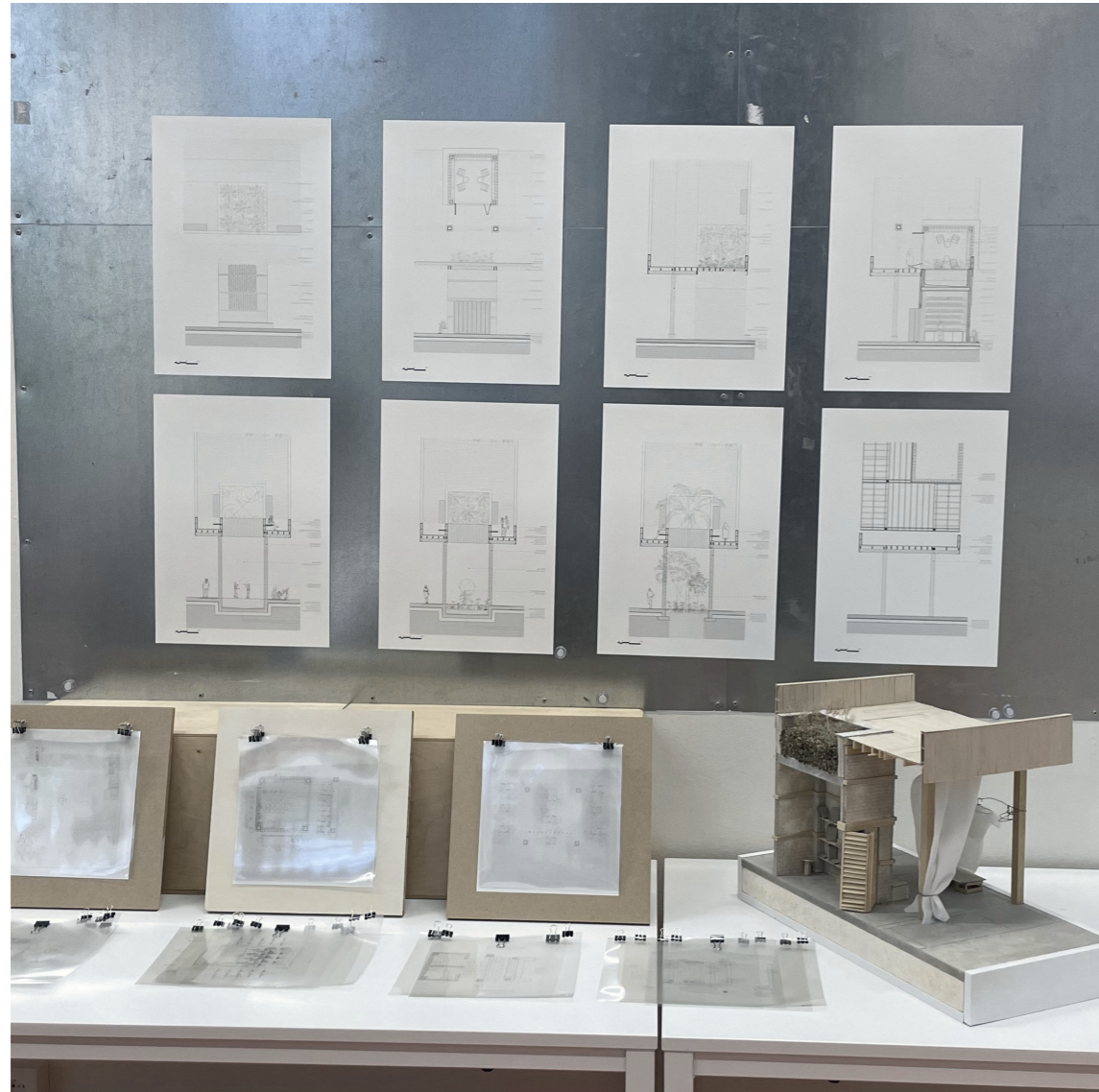



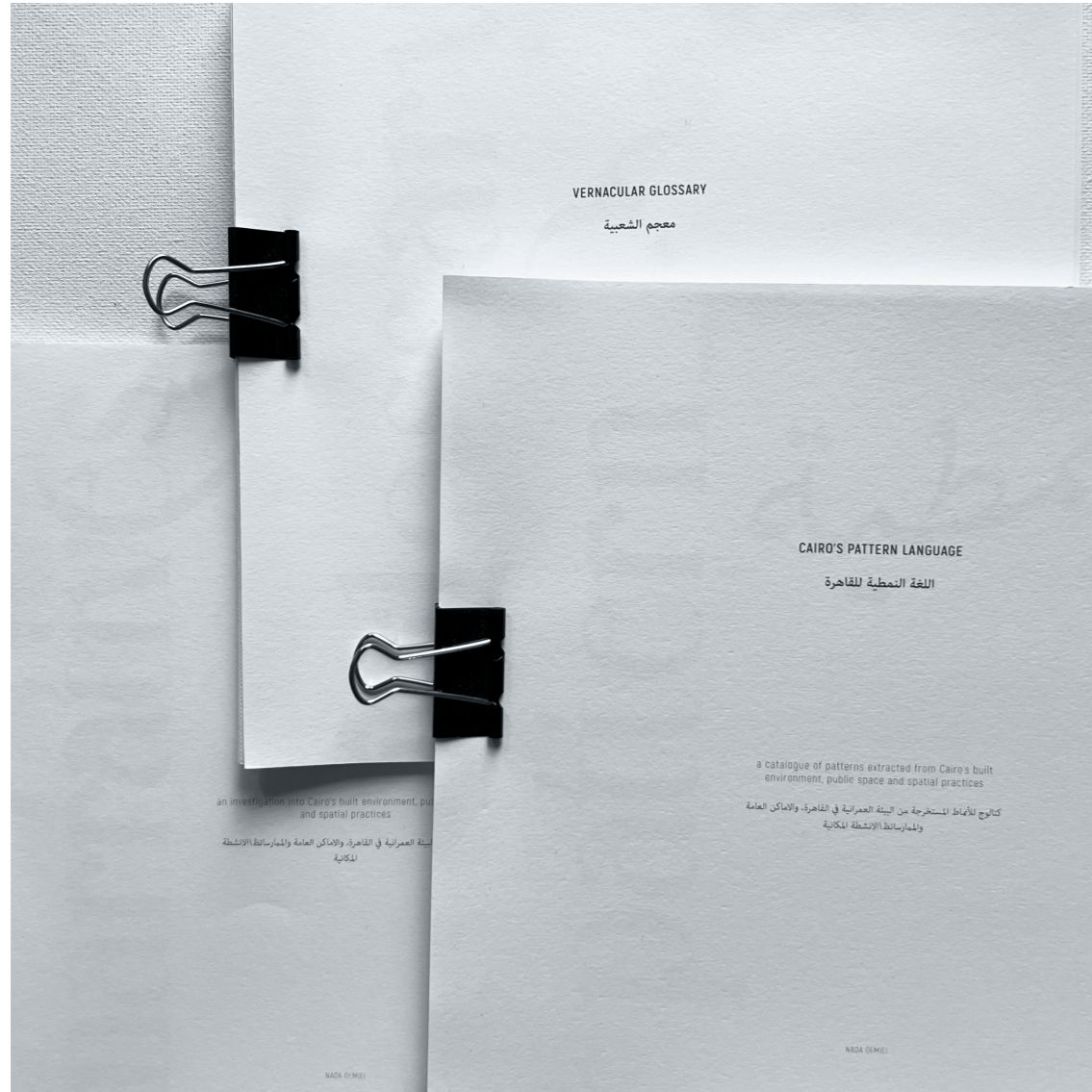

RESEARCH

booklets

The research is divided into three outputs, Vernacular Glossary, Urban Narratives and Cairo's Pattern Language. The Vernacular Glossary encompasses 24 terms to redefine the discourse on vernacular architecture in Cairo, Egypt and the role that language plays in its perception. The Urban Narratives conducts an investigation into Cairo's built environment, public space and spatial practices in Downtown Cairo, Islamic Cairo, Heliopolis, Nasr City, New Cairo and the New Administrative Capital. Cairo's Pattern Language is a catalogue of patterns extracted from Cairo's built environment, public space and spatial practices reflecting the relationship between people and their context.

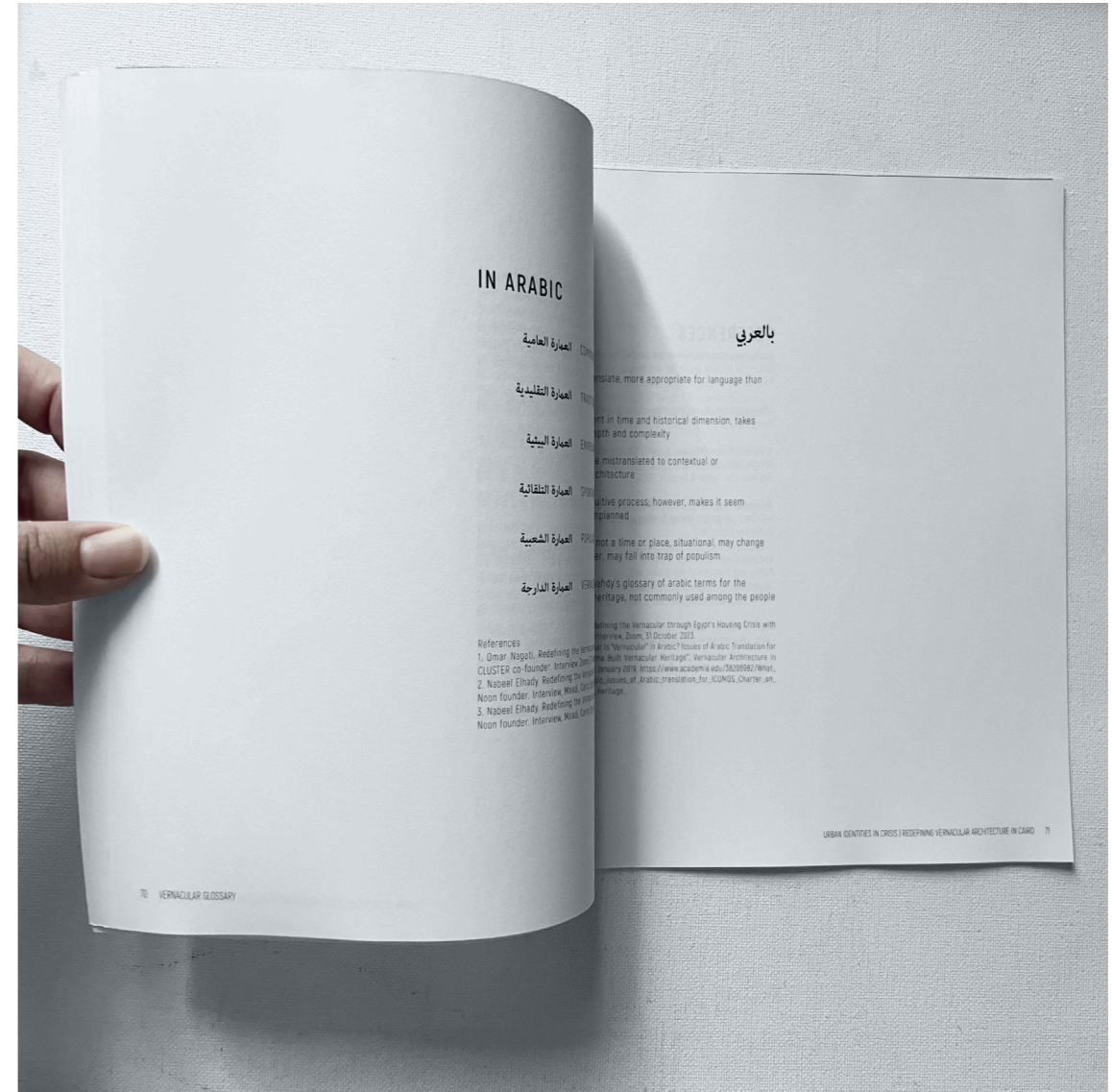



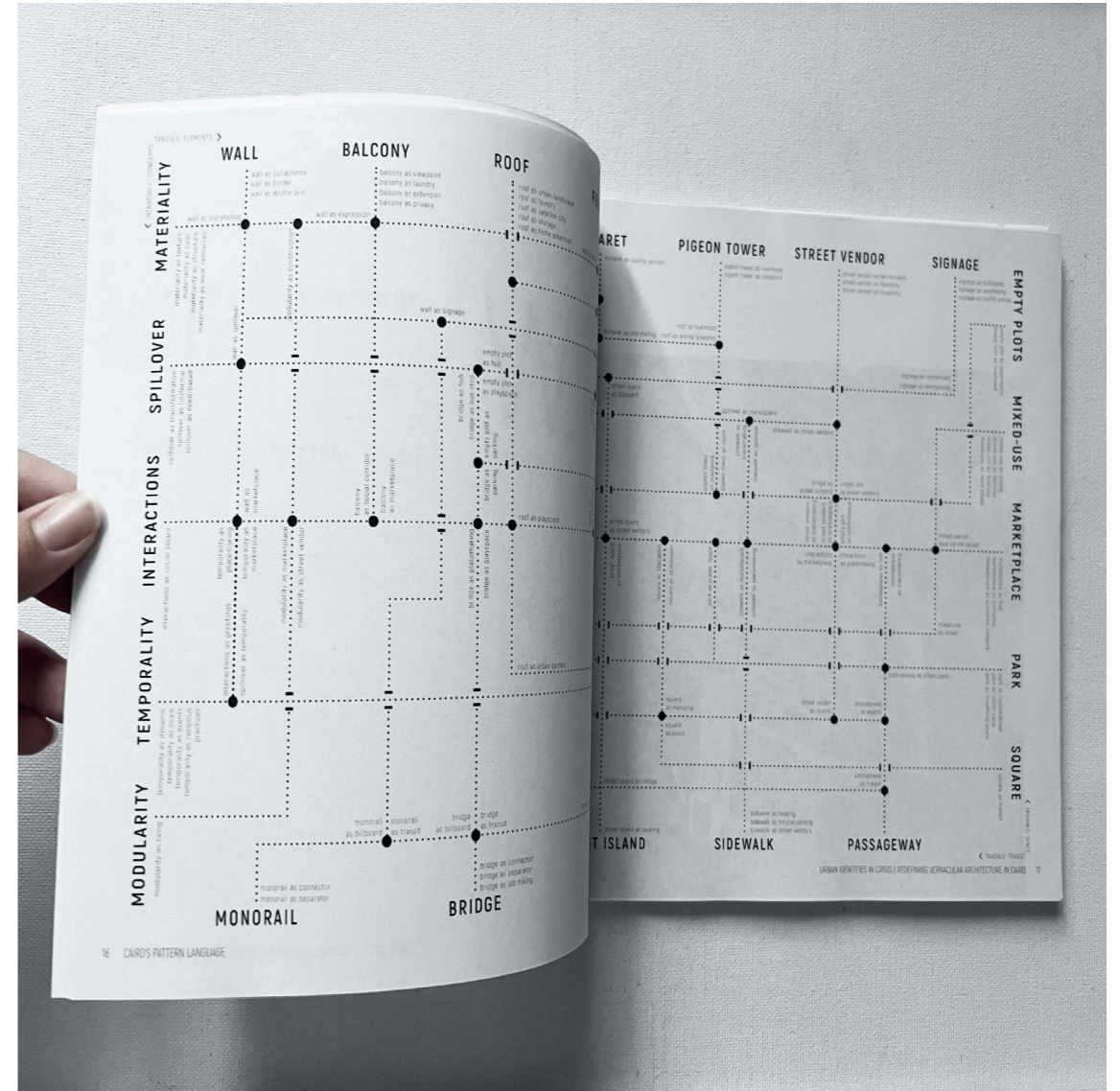

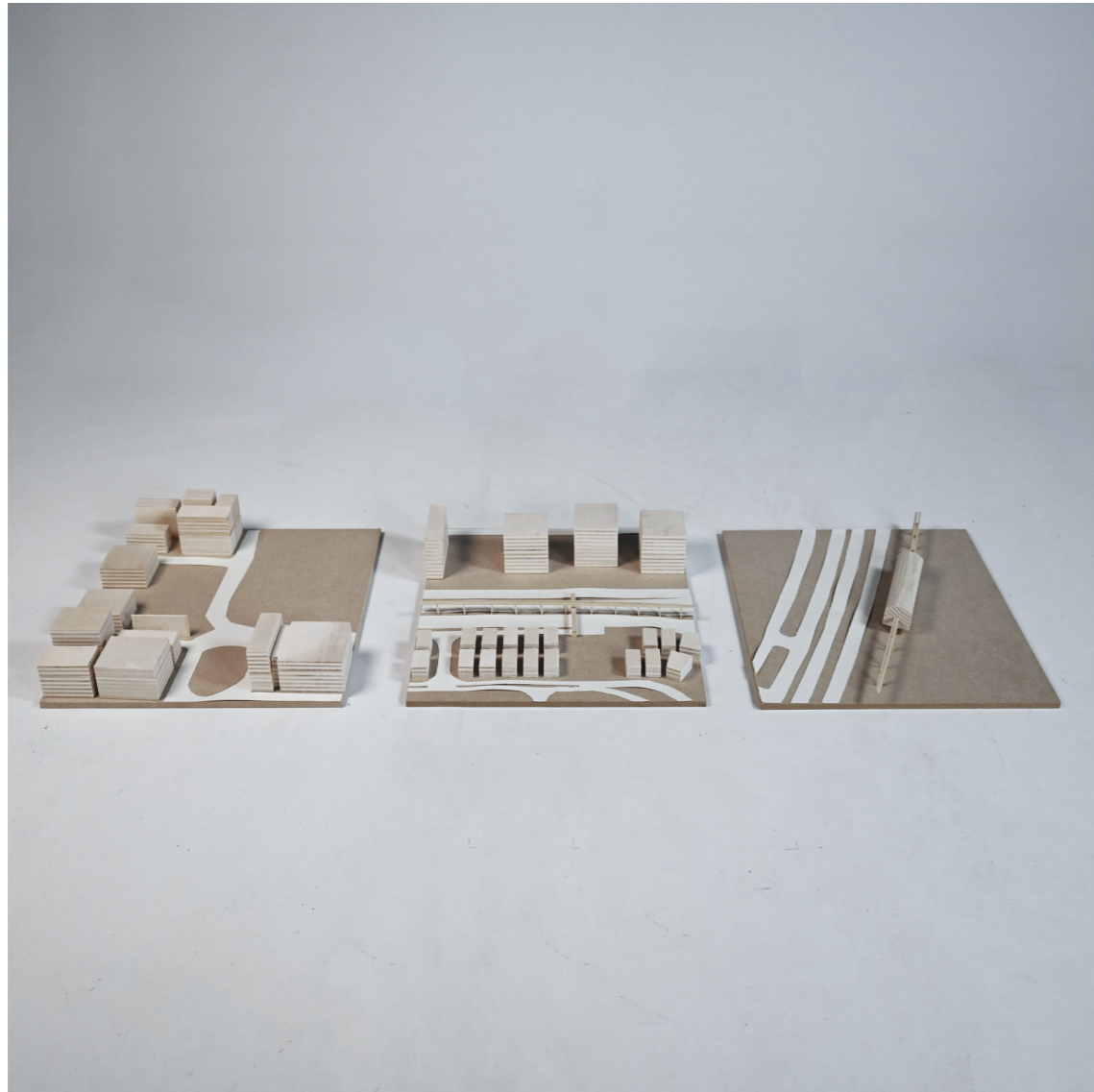

1:1000

model

Models of three explored sites, Downtown Cairo, New Cairo and the New Administrative Capital. The three models in the same scale highlight the varying urban conditions within Greater Cairo and exemplify the challenge of experimenting in different contexts within the same city. They provide the testing ground for further experimentation and incremental approach to design, testing theories and design proposals on one site and then transferring them to another site and moving back and forth.



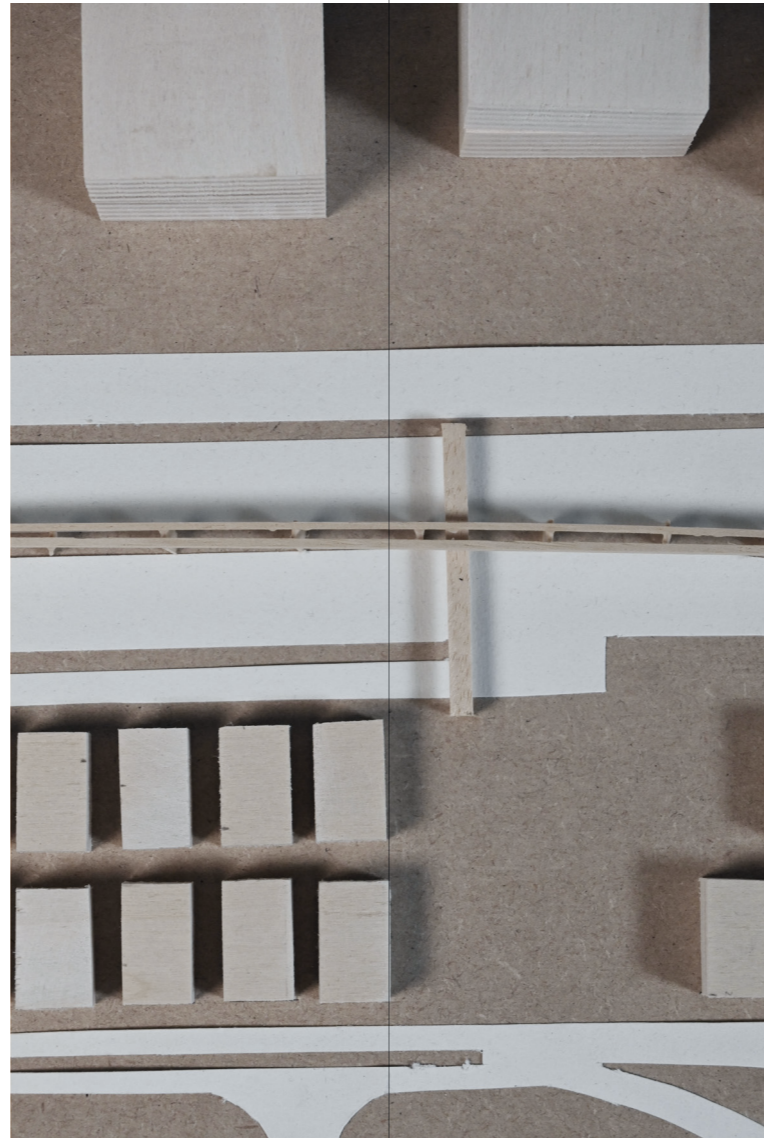



1:200

model

This model presents the design proposal in the Downtown Cairo context. It demonstrates the tension that exists between the Continental Hotel and the vernacular spatial practices approach to designing spaces. The model also showcases the relationship between the intervention and Al-Azbakeya Garden and Opera Square and highlights the power of architecture to break existing borders and edges within the city. The model is also designed as a section and reveals the underground metro that leads to Attaba station, integral to understanding the layered dynamics of the site.







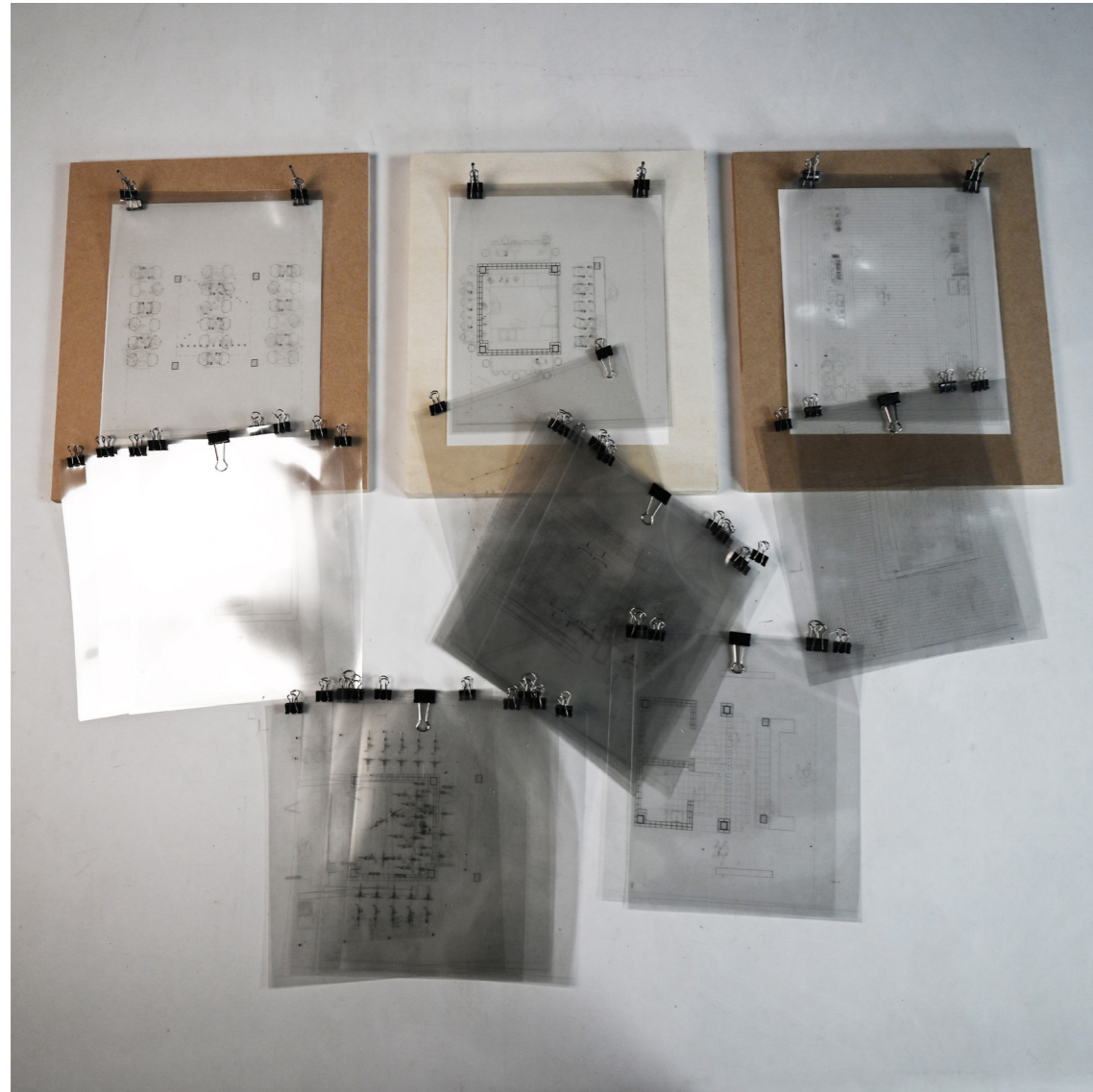

1:50 model

This experiential model is designed to highlight the endless possibilities of use of the modules designed for the intervention. It highlights the adaptability of the prototypes to different functions responding to their context and user groups. The model is divided into three parts, the interior of the brick module, the ground space between the structural modules of the platform, and the upper level of the platform.

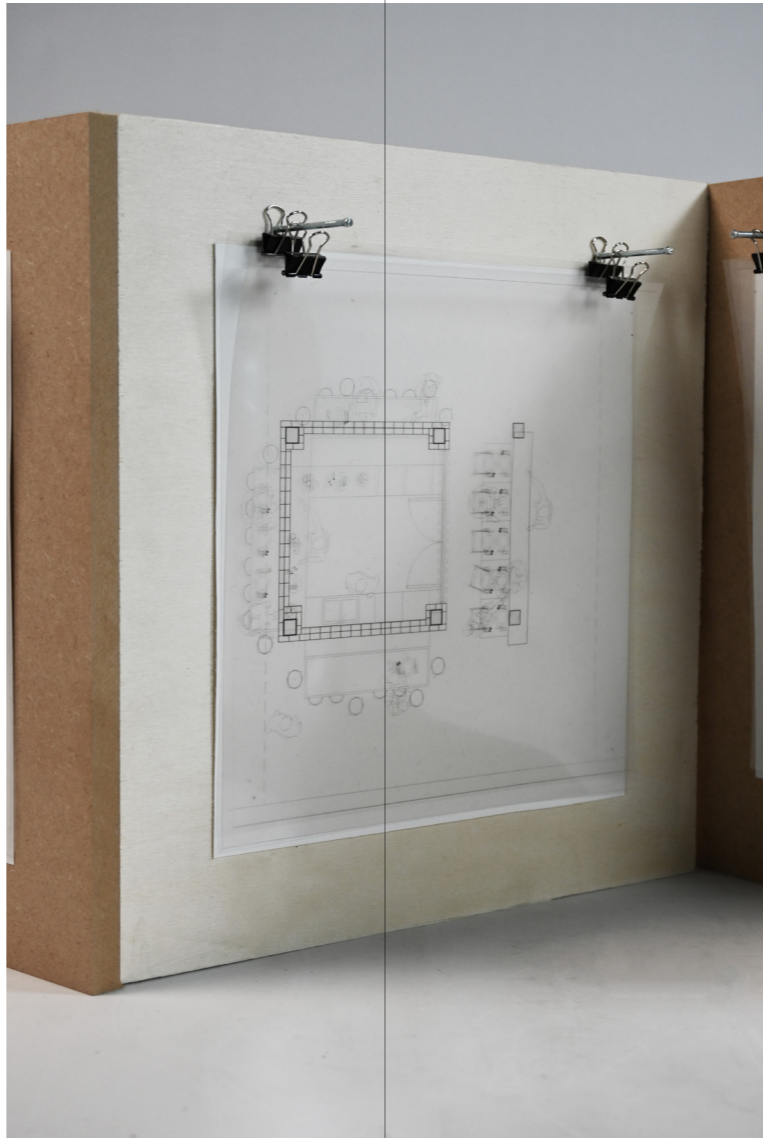



1:25

model

The model explores in extreme detail the materiality as well as the structural integrity of the intervention. The details of the brick and wood connections explore the tactility of the proposal and its connection to people and place. Furthermore, the model highlights the nature of appropriation and spatial practices. Although suggestive architectural elements are intergrated in the design, the architect yields control and surrenders to the spontaneous and sometimes chaotic nature of these spatial practices.





