

The Process

Veronica Cristofolletti
Methods and Analysis | Graduation Studio 2017.2018

Working/Living



Poblacion Obrera la Union, Valparaiso



Pisco Elqui, Chile



Palermo, Sicily



Palermo, Sicily

Communal Living Rooms



Scilla, Italy



Ciudad Abierta, Chile



Licata, Sicily

Manufacturing Windows



Licata, Sicily

Windows of Trade



Valparaiso, Chile



Valparaiso, Chile



Salemi, Sicily



Valparaiso, Chile

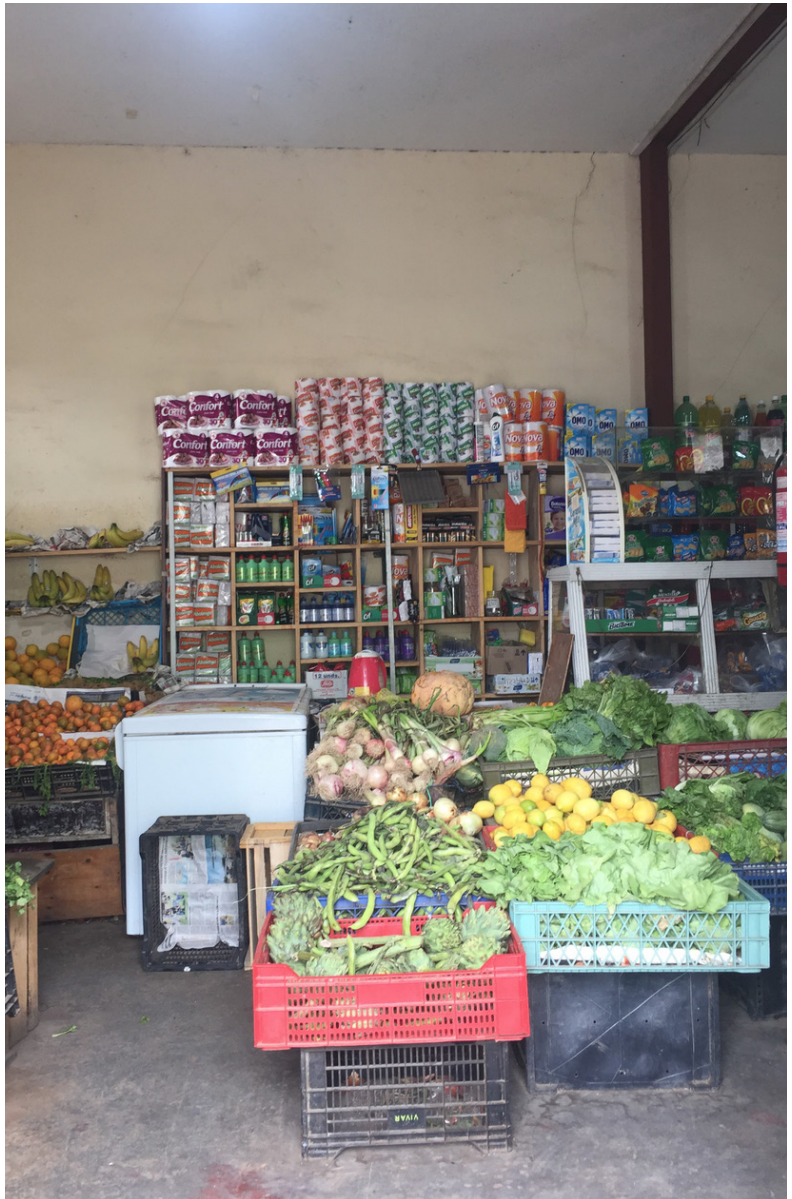

Valparaiso, Chile

Trading Paths



Valparaiso, Chile



Valparaíso, Chile



Valparaiso, Chile



Valparaíso, Chile



Catania, Sicily



Monreale, Sicily

Working Spaces

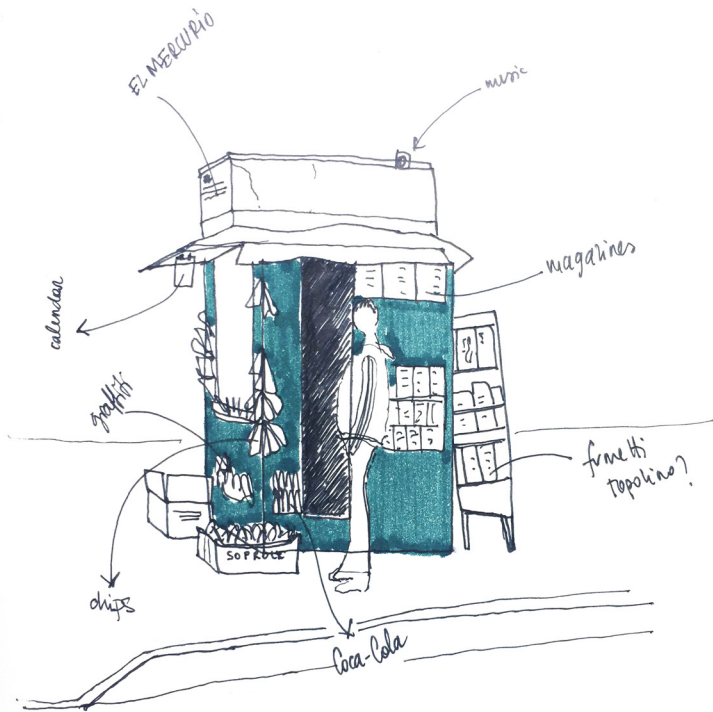

LA CHICA

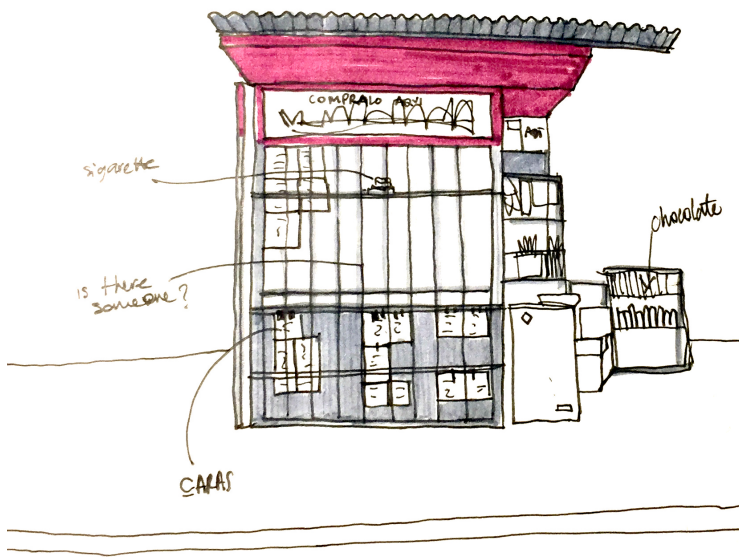

LA PRISON

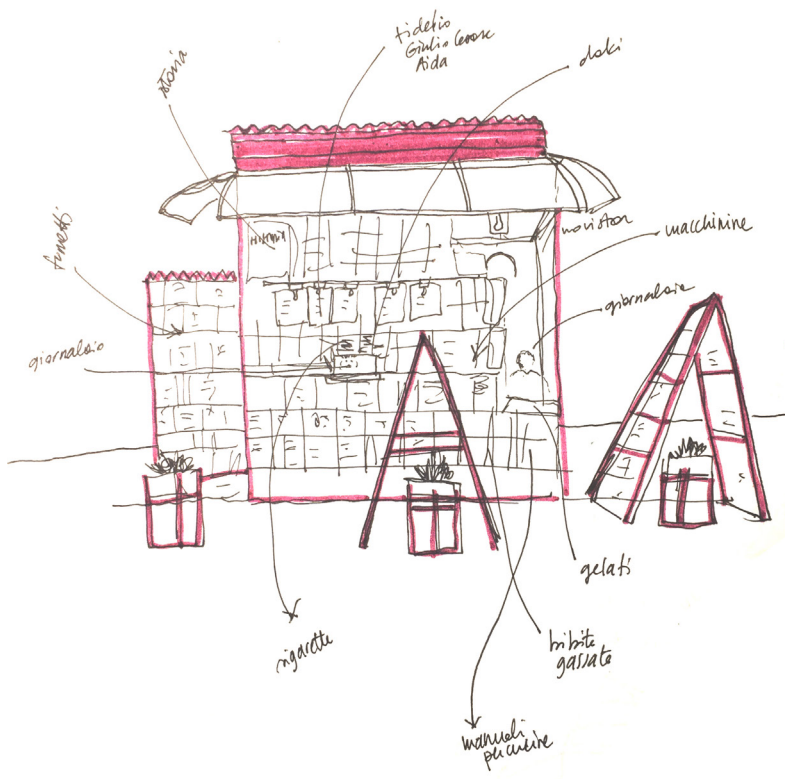

LA ROSA
 LA ROSA

Inside, there is a man
sitting on his chair,
surrounded by his cigarettes,
his chewinggums, his newspapers.

A man, sitting inside his
chappel, a guardian of
the street.

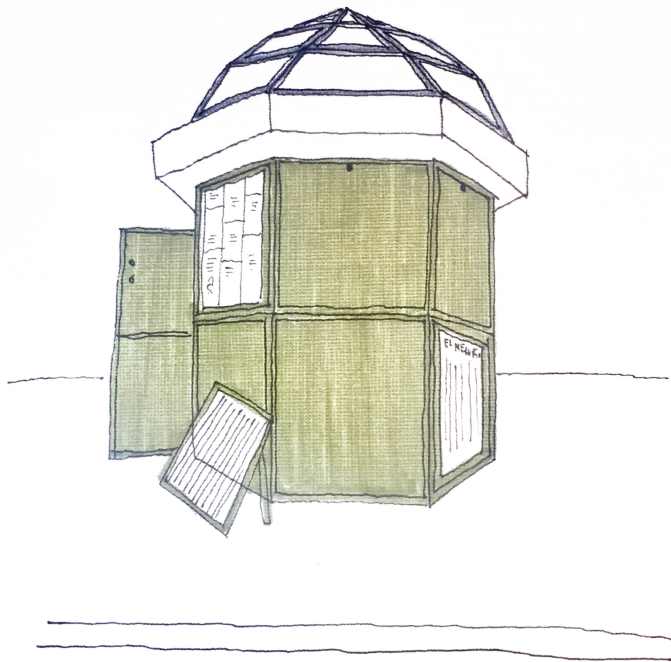

- LA CAPPILLA -

TAILOR SHOPS :



storing material in the vertical element of the wall

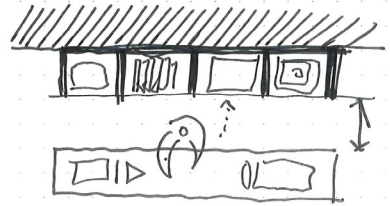

in my case :

should this element be like "prefabricated one" →

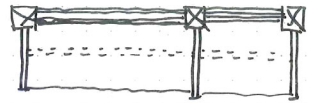

column string

*

the storage wall
the storage beam...
/ ...entire wall

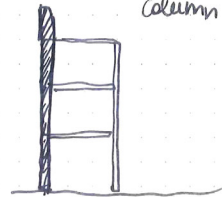

CROCHET
(seamstress)

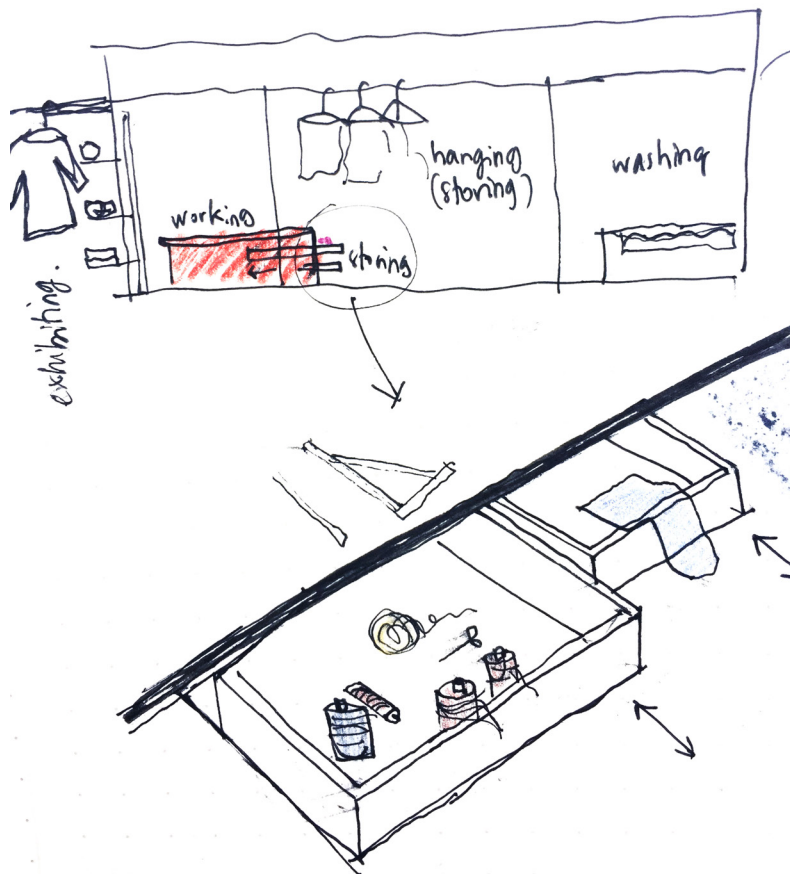

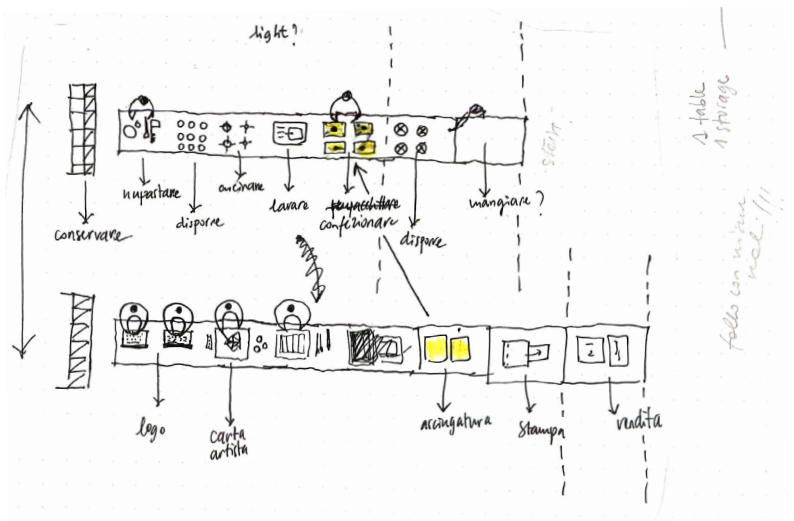

Comparison between a kitchen and a place for artist and designer

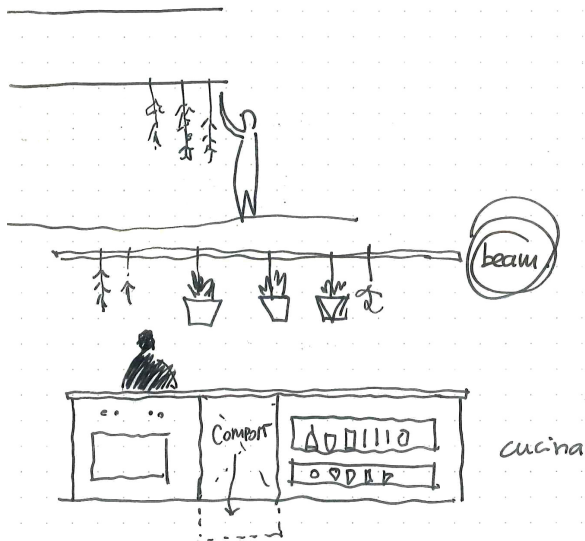

it works well for ~~the~~ storing food but not for other activities

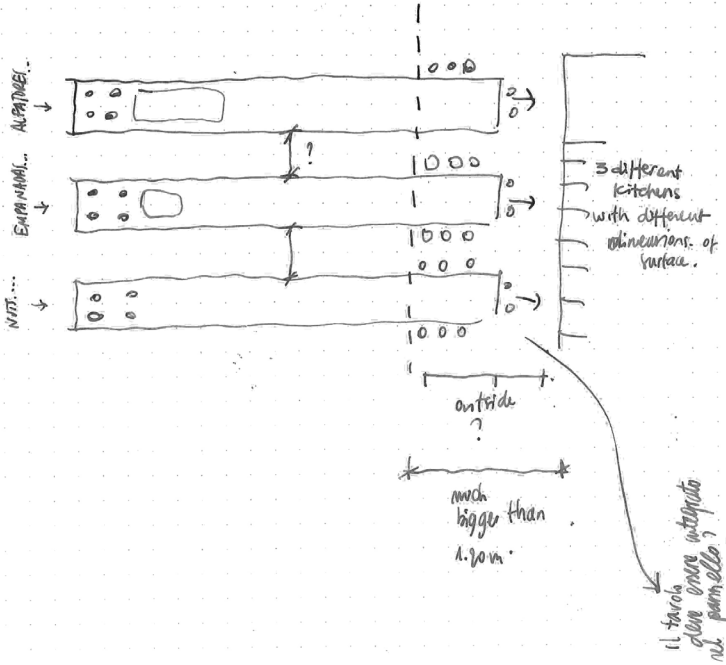
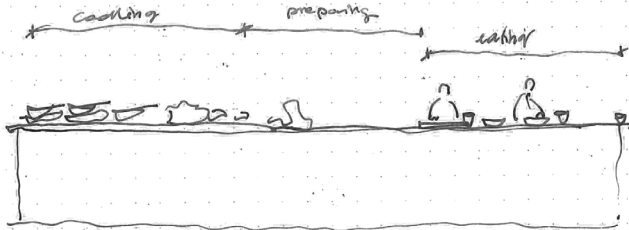
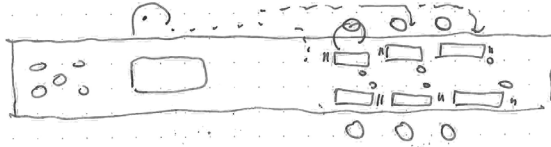

The Kitchen

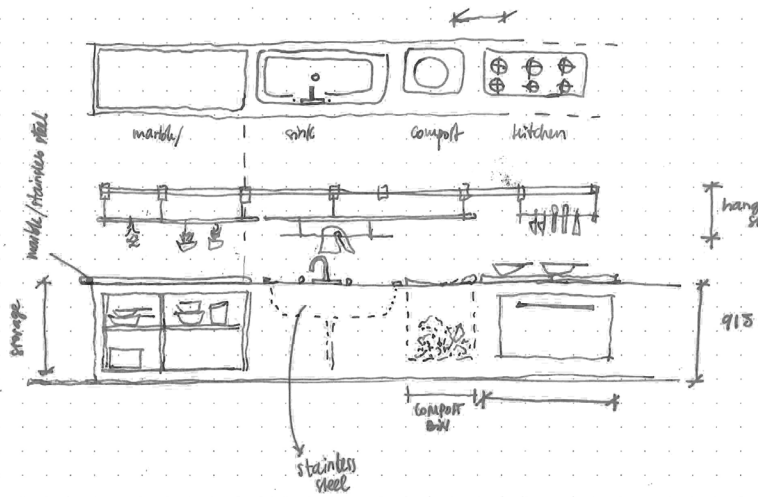

What is the right order / the right distribution?

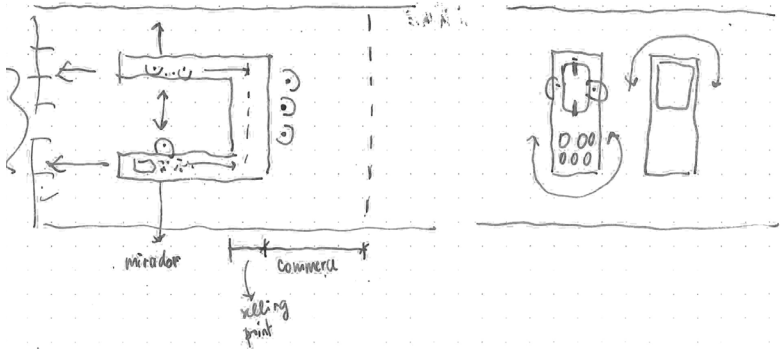

What: How a coworking kitchen should look like?

↓
cooking together
sharing:
but also enough
space for individual
creativity.

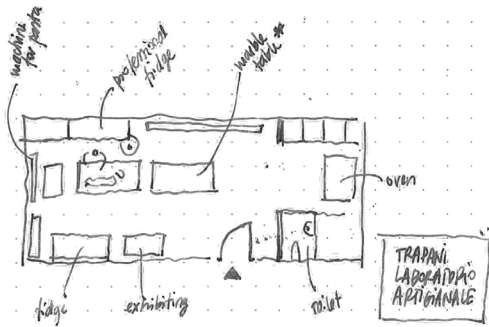

* the surface of
the working table
is really important.
↓
MARBLE, easy to clean
to work...

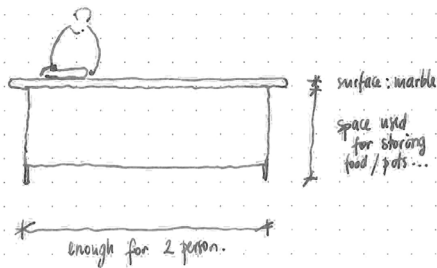

The Structure

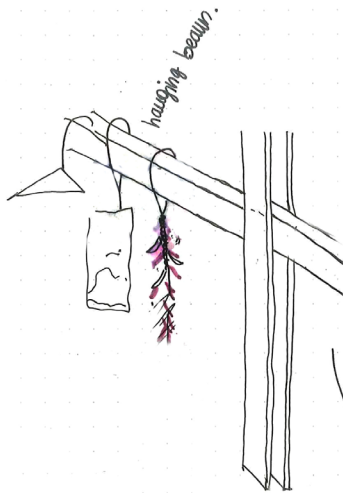

this system is more flexible!

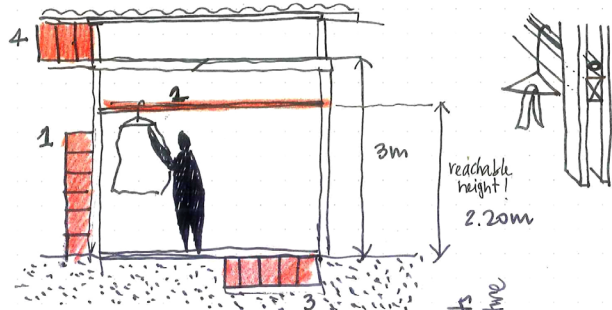

storing: the column (wallpaper)
 the beam
 the floor (the ground)
 the roof.

regulate elements in the structure

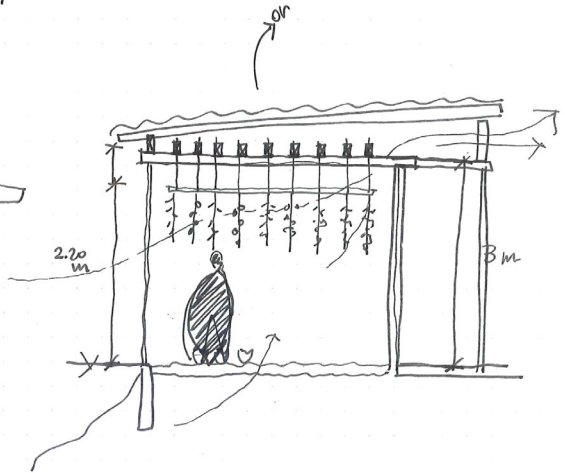
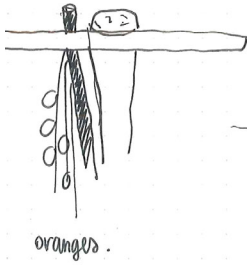
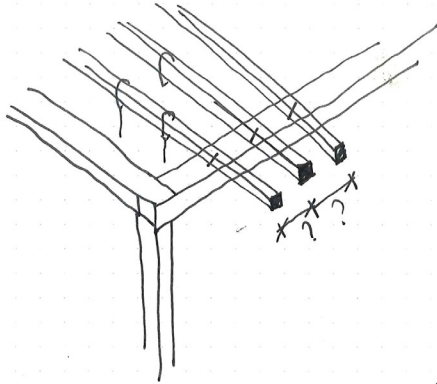

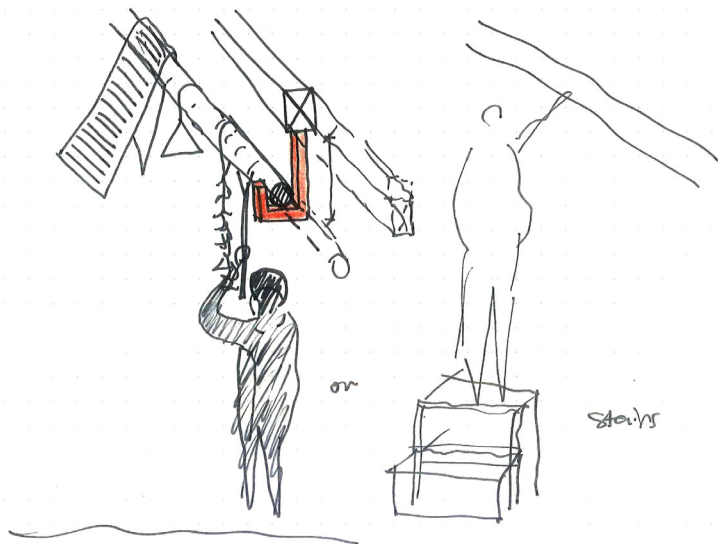
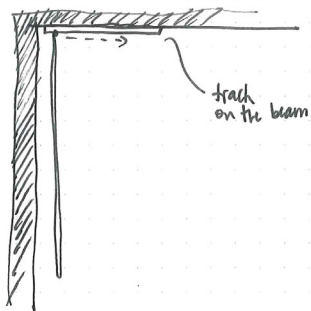

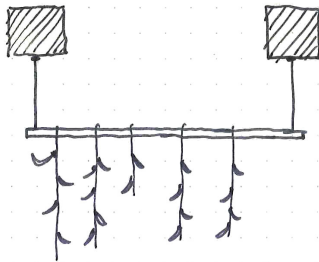
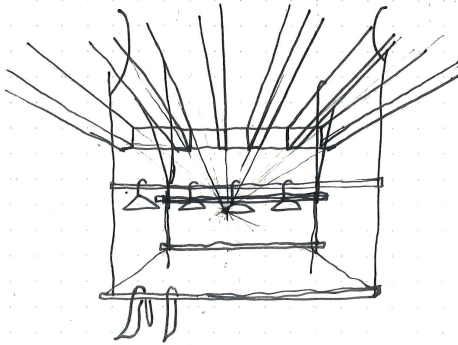

simple system ←
→ How to make more "flexible"

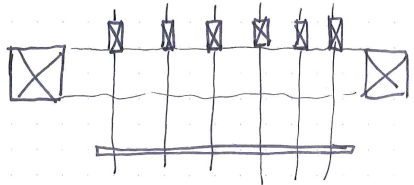

* you don't need anymore a storage room! → but the wall itself is a storage.

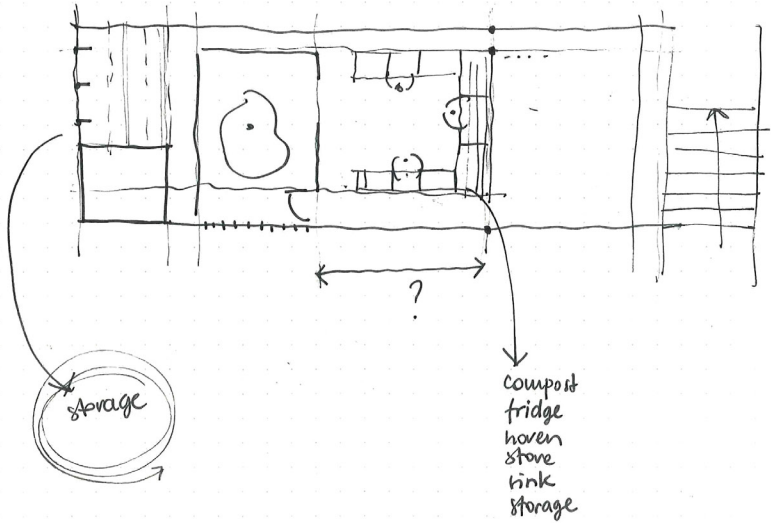

the storage panel!

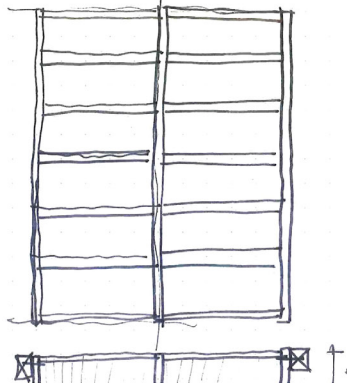

Storing

Storing/Exhibiting

→ at night ~~you~~ you just put the products back inside

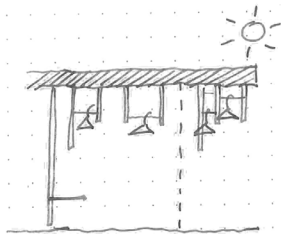

During the day the product are exhibited in the exterior space close to the public path.

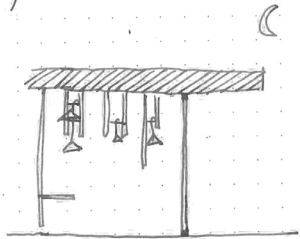

At night the products can be easily put back inside.

the action of "storing" and "exhibiting" happens occurs on the structural element of the joists.

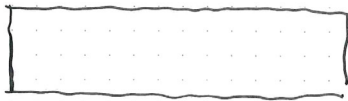

everything
can be hanged to
from the roof?
W. Segal.

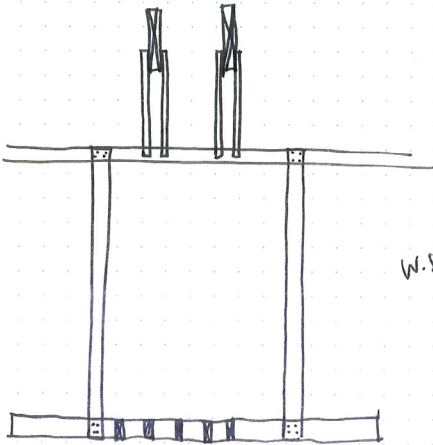

W. Segal.

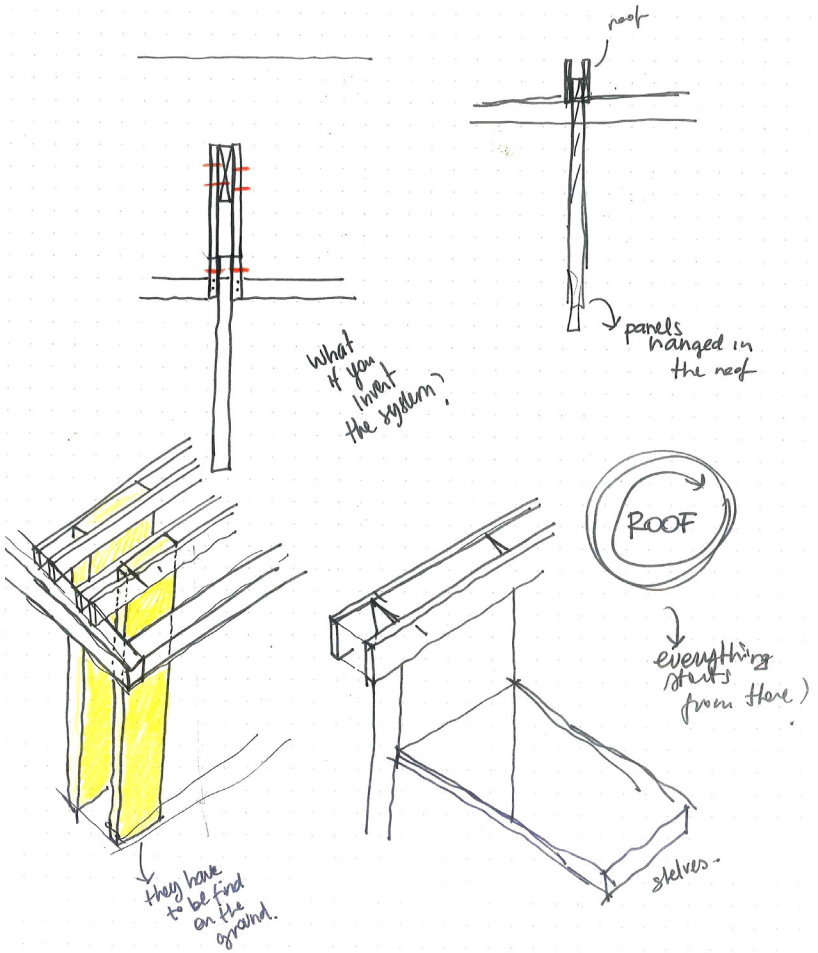

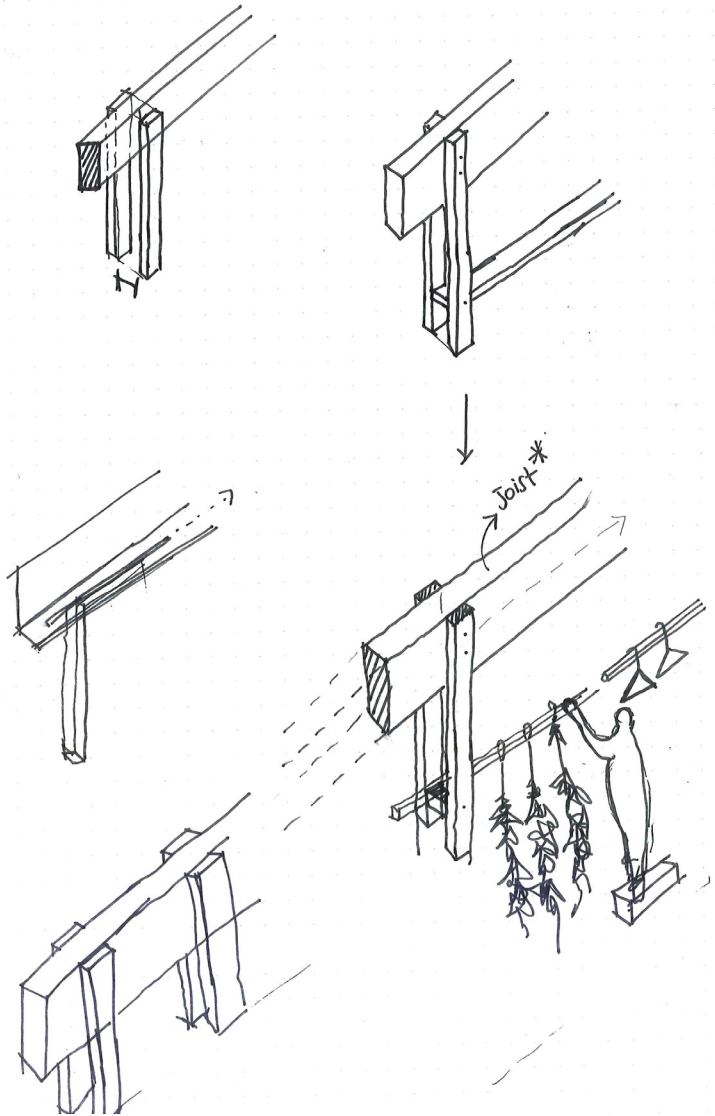

The Beams

↳ From the roof joist you can hang ~~everything~~ anything W. Segal.

Storing in "vertical" ✓

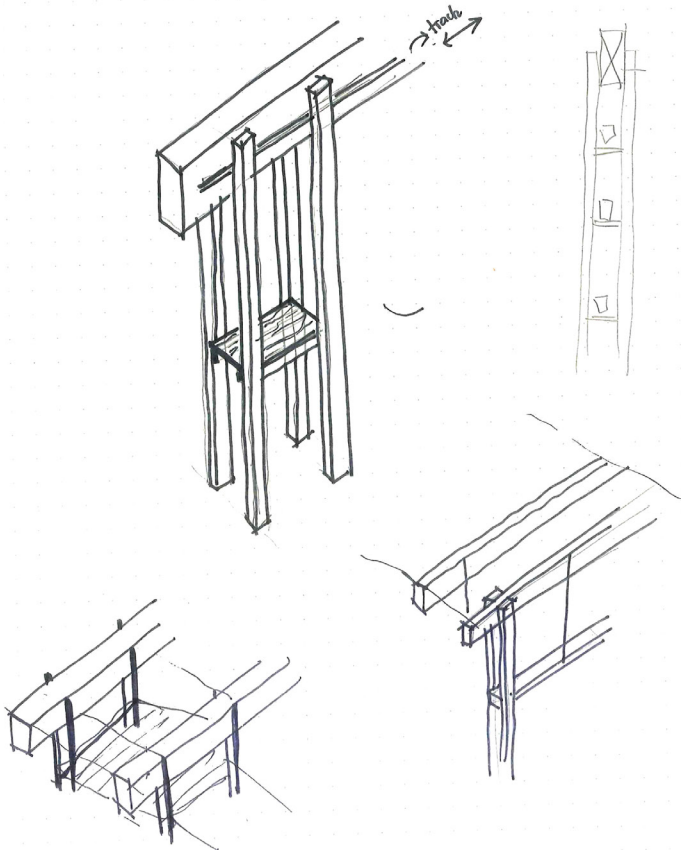

! window is light. Is a frame,

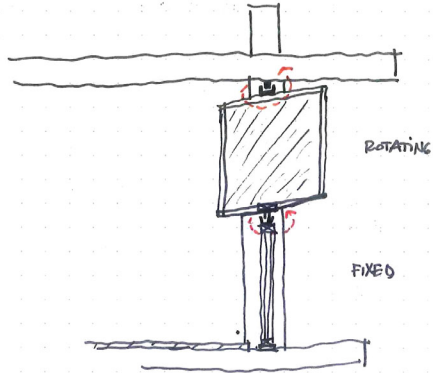

(rotating)

PANELS:

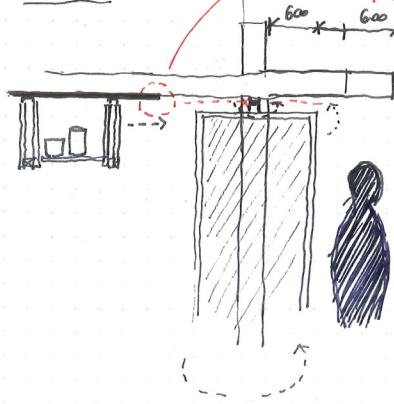

2. it becomes a very narrow space when the door is open, so I could offset inside the others

1. it can reach the exterior because there is the panel!

(I would like arrives out because it as 'exhibiting.

Can also be