



## **CINEMASCAPE**

RESEARCH JOURNAL

Jackie Chak-kei Ho

*Urban Architecture Graduation Studio 23-24*



Photo: Gert Schutte

**Observatorium**  
Robert Morris  
Lelystad, the Netherlands  
1977



**Moses Bridge**  
RO&AD Architects  
Fort De Roovere, Halsteren, the Netherlands  
2011



Photo: Siebe Swart

**Celestial Vault**  
James Turrell  
Kijkduin, Den Haag, the Netherlands  
1996

*Land art projects as highly distilled examples of exaggeration and re-framing of nature*

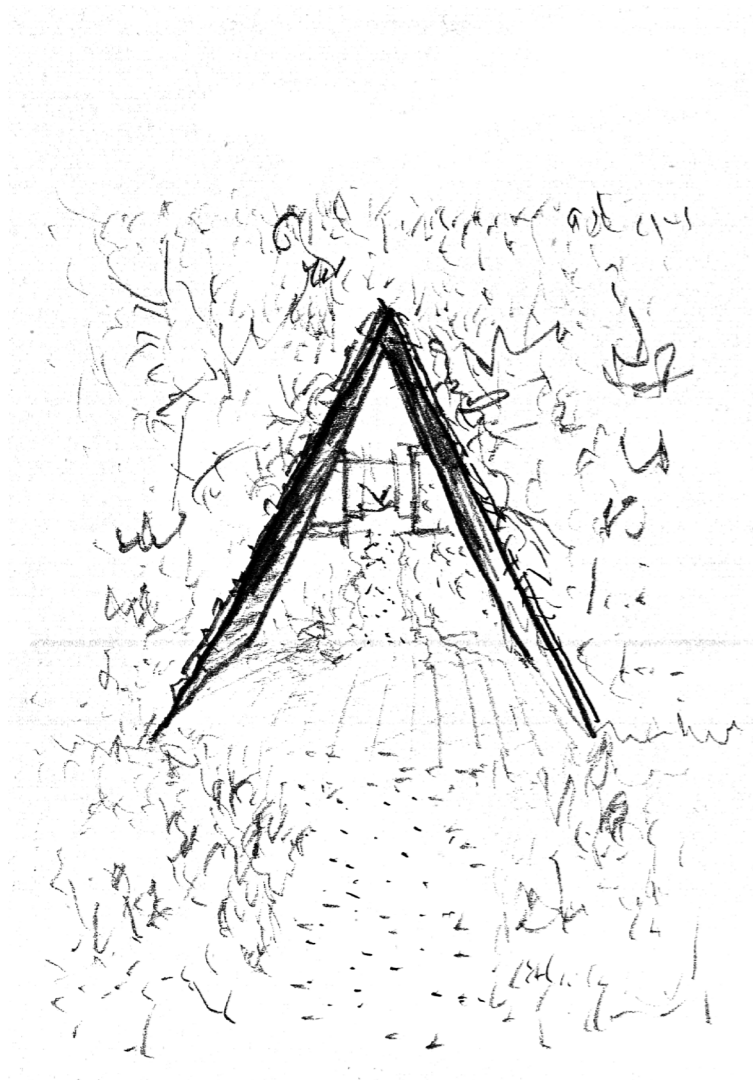

### Observatorium

seasons becomes visible with the sun rising through the openings on the solstices and equinoxes



### Moses Bridge

offers a new vantage point with the waterline at chest height, emphasizing the body's spatial relationship to the ground plane

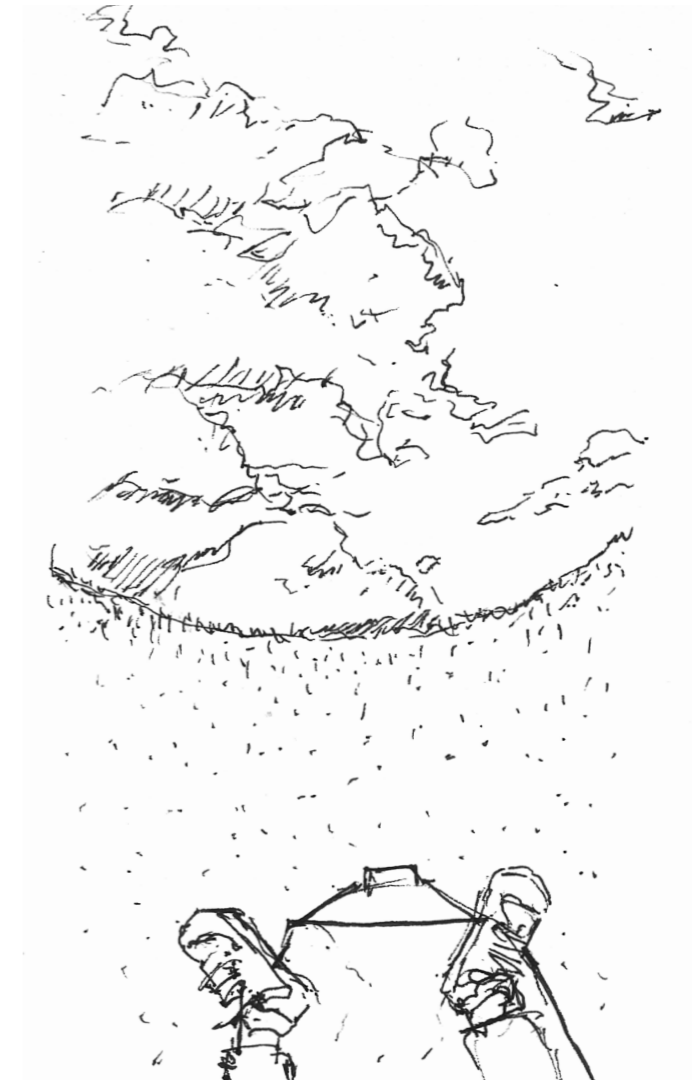

### Celestial Vault

the artificial crater formed the edge of the enclosure to frame our view of the sky

*Vantage Points - serve as magnifying glasses which momentarily confronts and re-centers our encounters with nature*



**Observatorium**

a shallow earthen mound seamlessly merged with the polder landscape

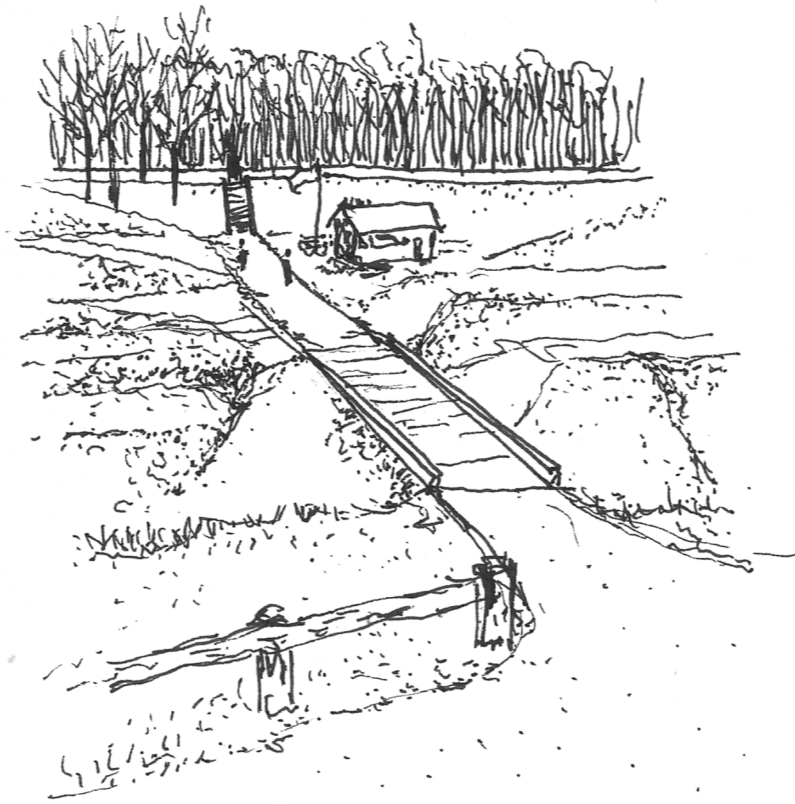

**Moses Bridge**

an invisible bridge sunken into the slopes and water



**Celestial Vault**

nestled in the site's gentle topography of dunes

*Approach: relative unobtrusiveness or secrecy from the outside*

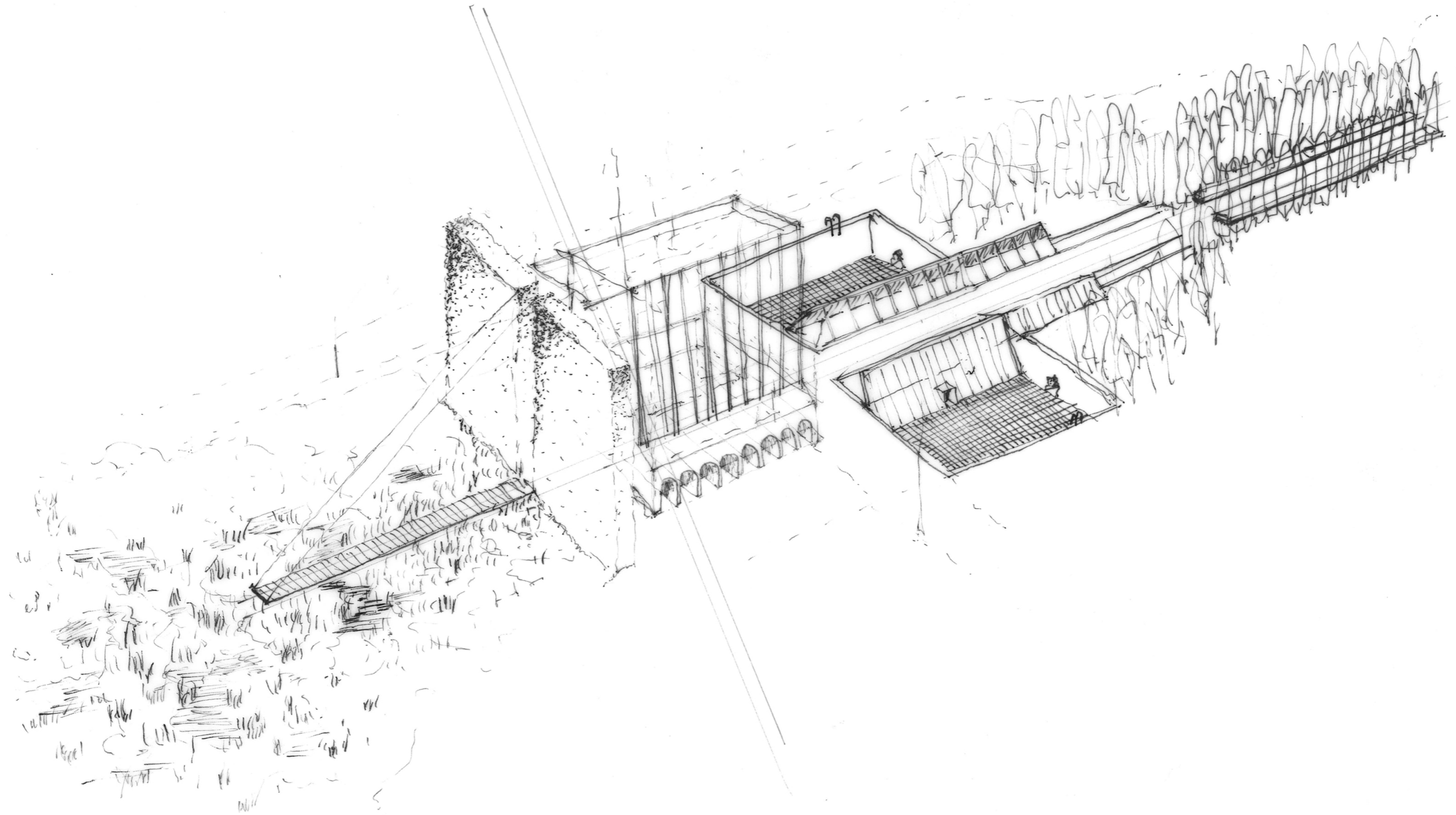

*"A pier offers no way out. All piers ,,, remain beautiful, melancholy monuments of frustration."  
Robbrecht en Daem*

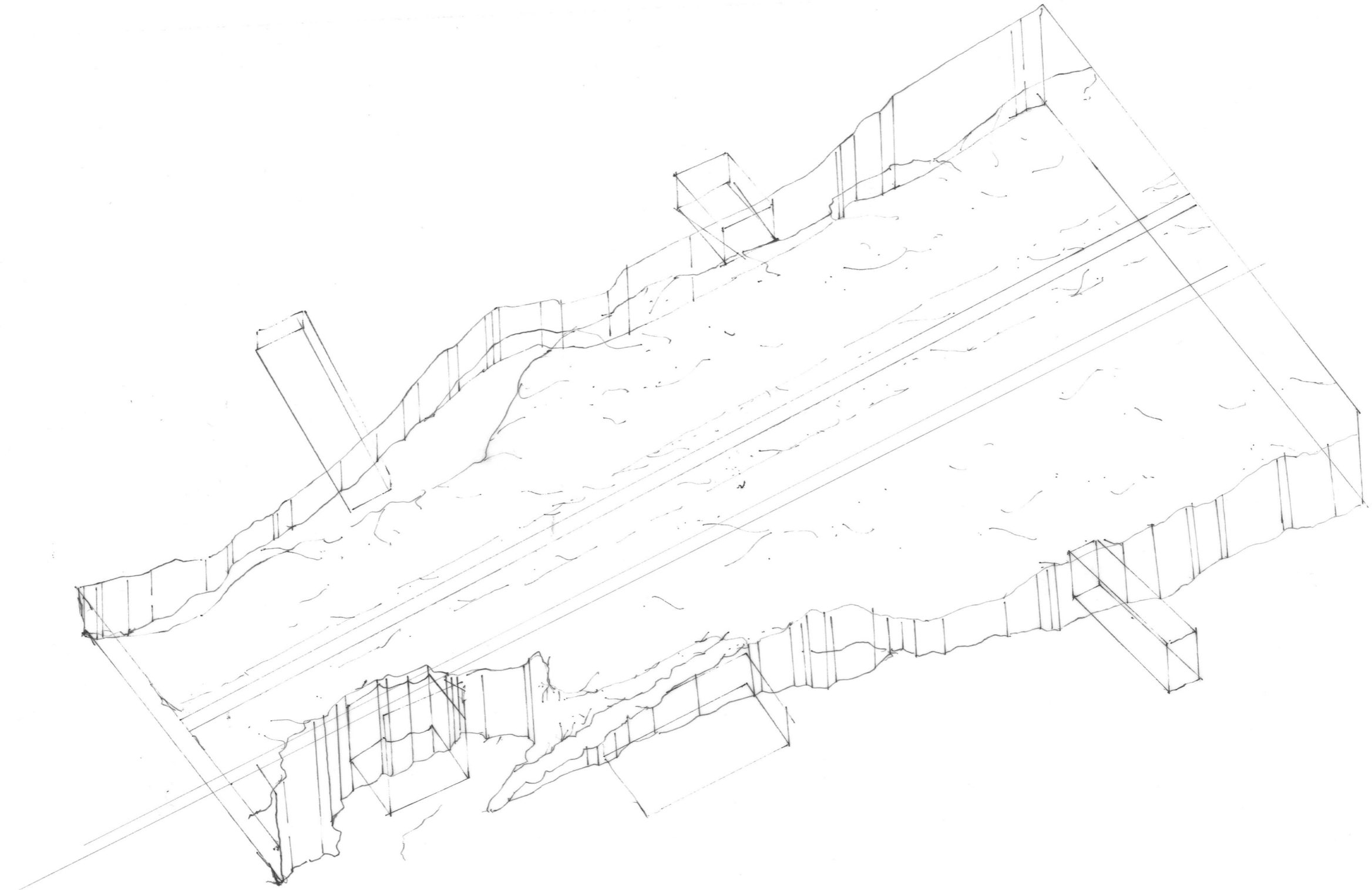

*entrances into Josaphat Valley*

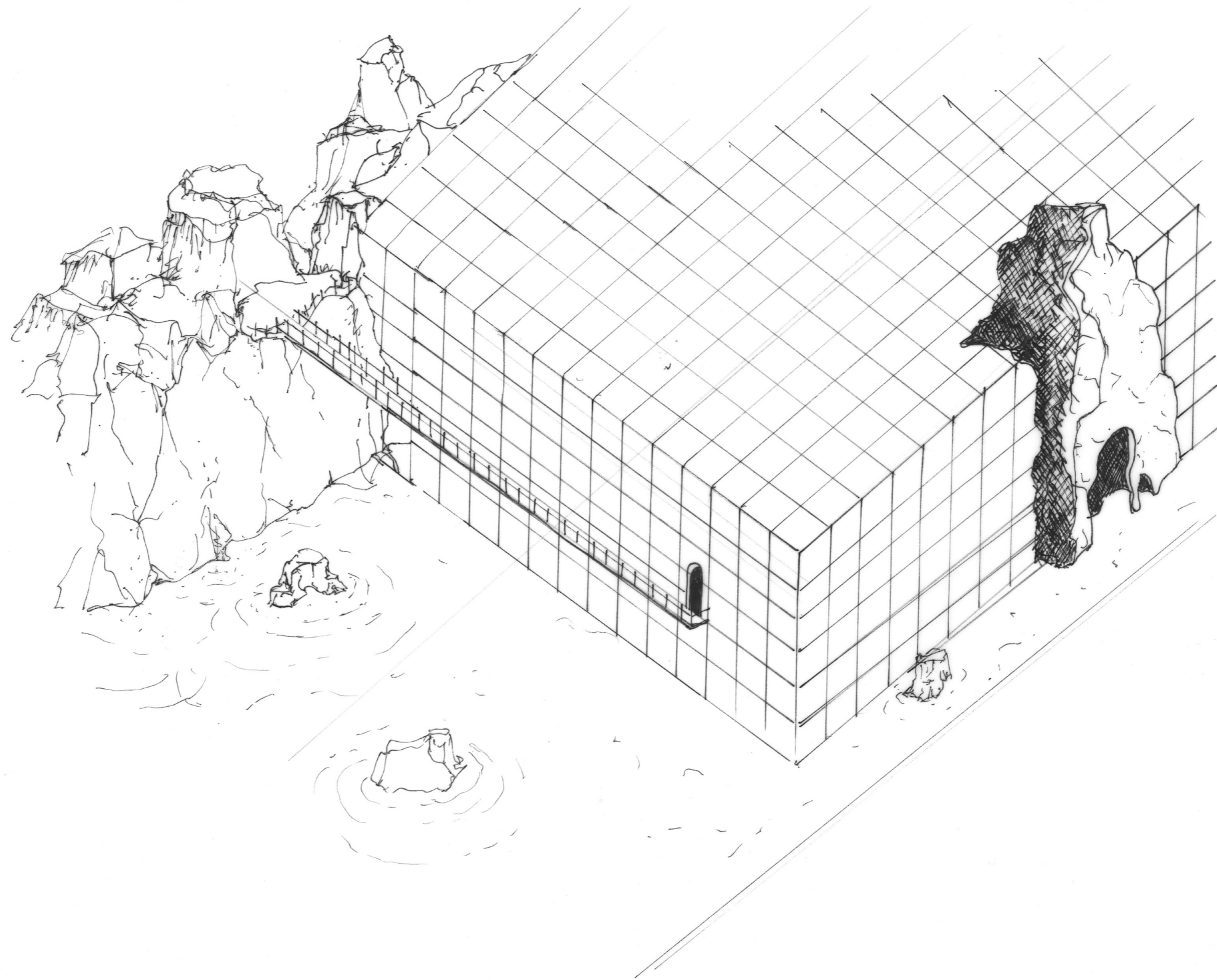

*from cliff into cube*

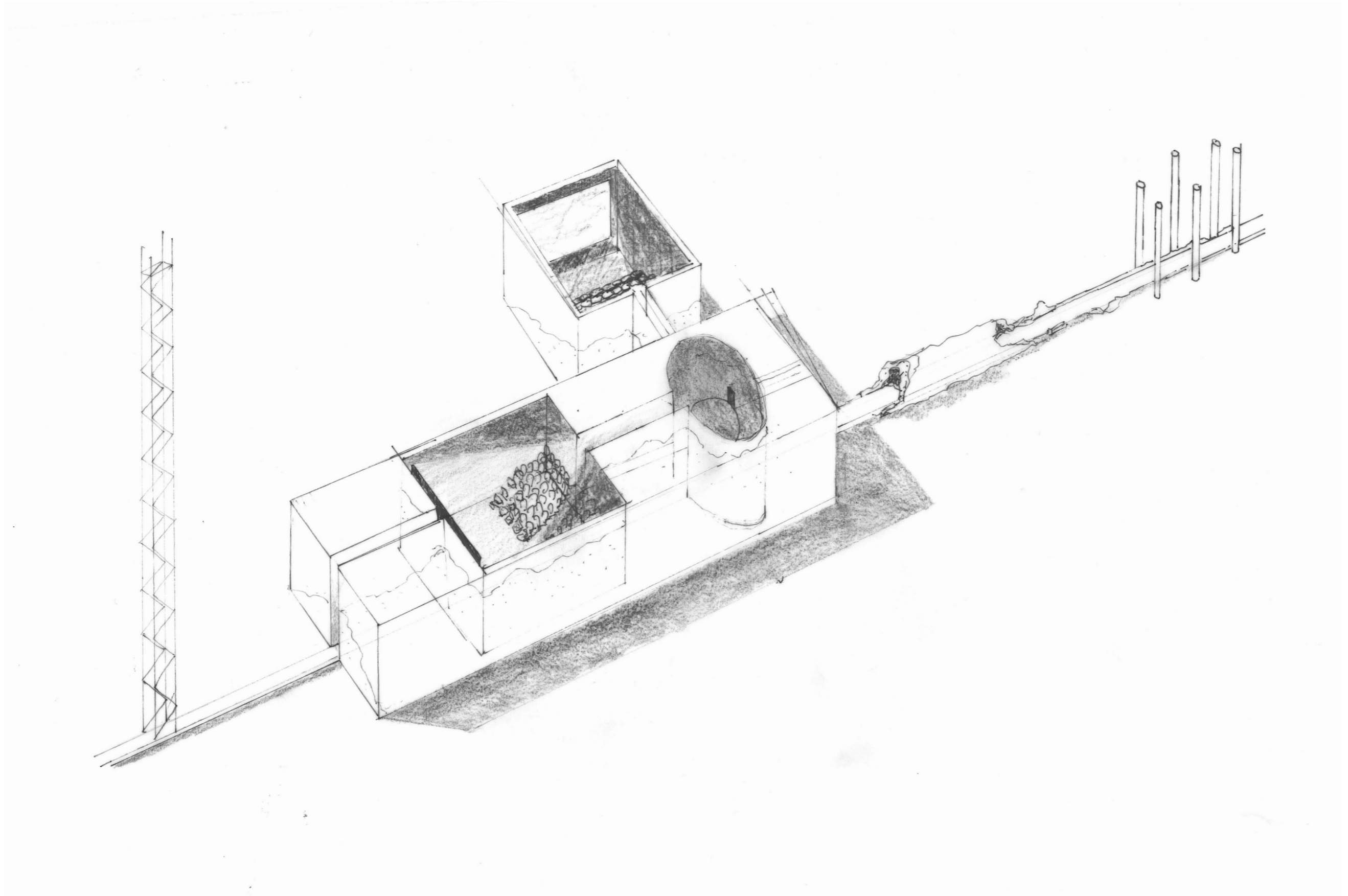

*stair, square, oval, tunnel, arcade*



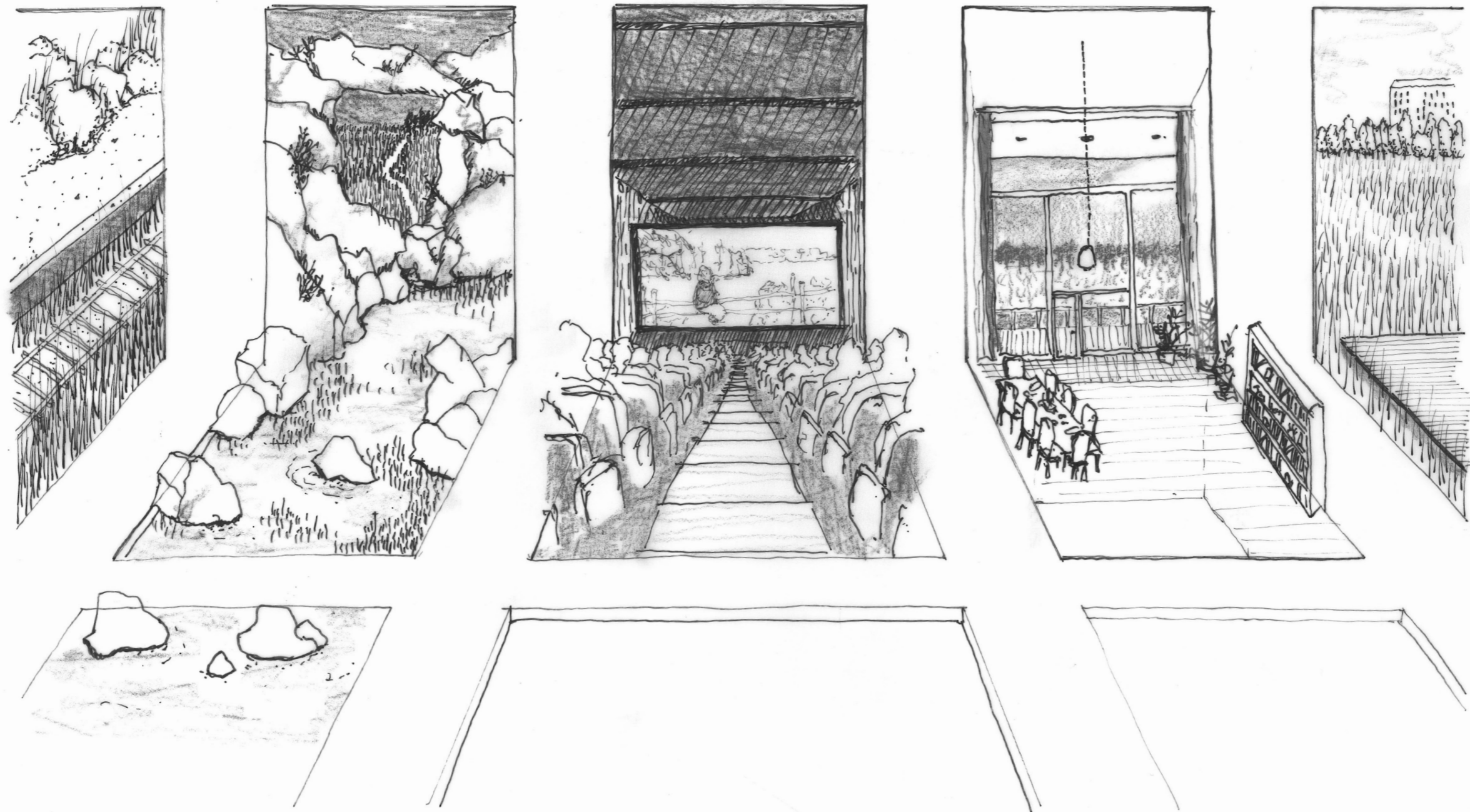

*vistas from different points of the journey*

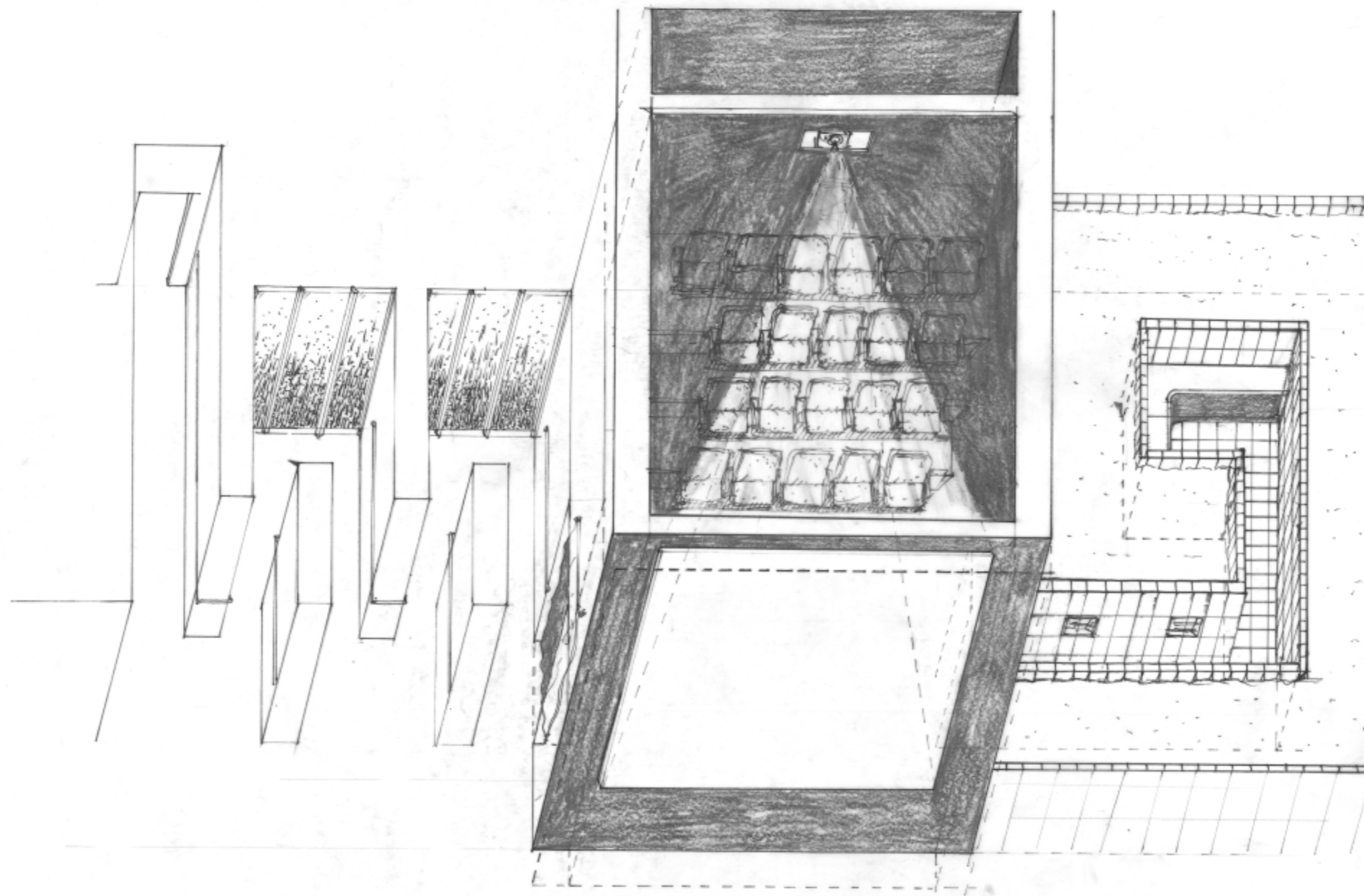

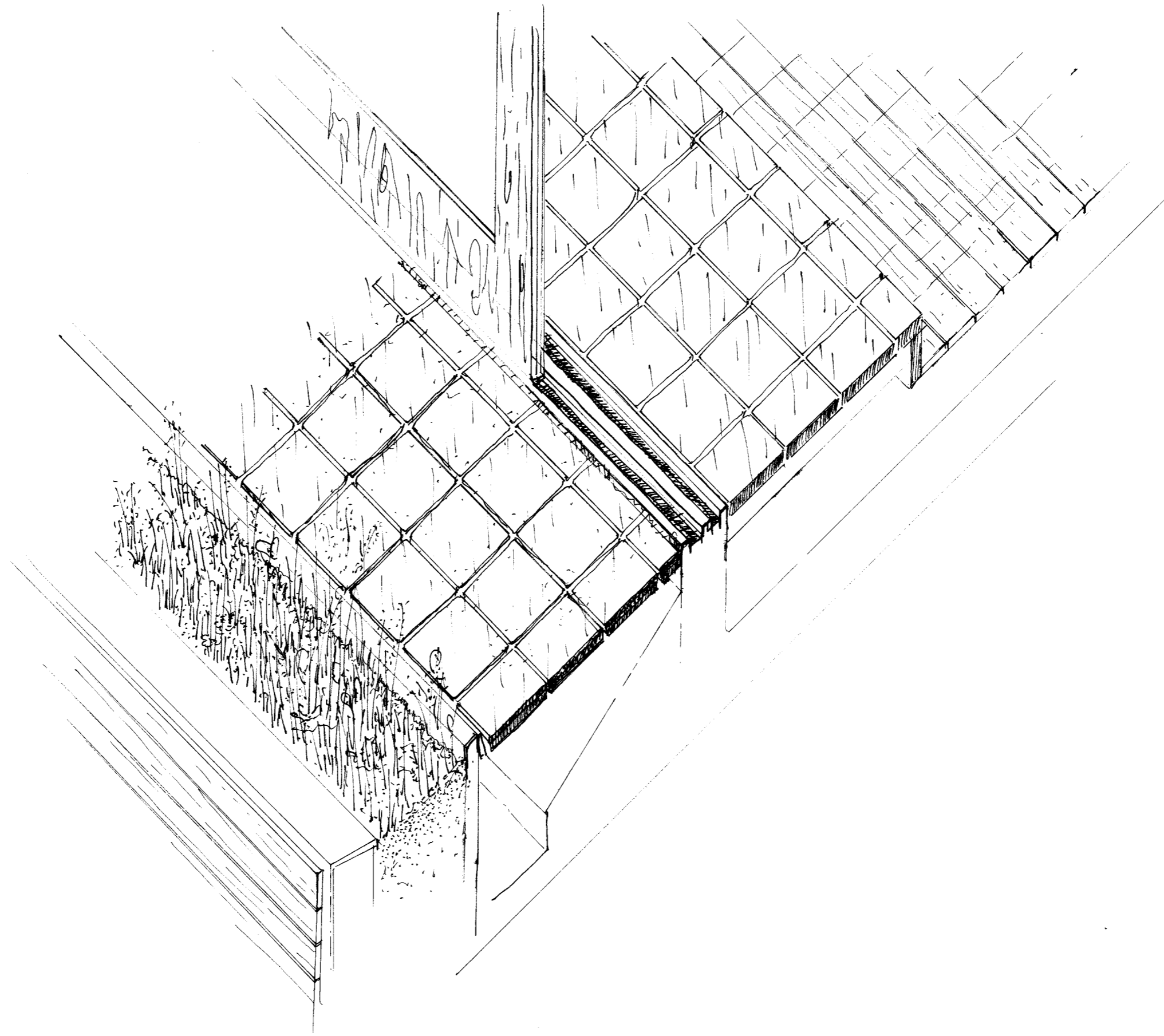

*from indoors to outdoors to the Friche*

@A4



**Observatorium**  
Robert Morris  
Lelystad, the Netherlands  
1977

**Meuse Bridge**  
RGSAD Architects  
Fort De Roovere, Halbeuren, the Netherlands  
2011

**Cultural Youth**  
Janus Turid  
Rijswijk, Den Haag, the Netherlands  
1996

@A4

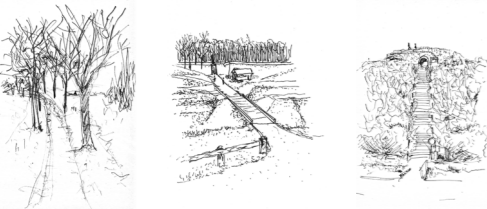

**Observatorium**  
A shallow and thin metal assembly merged  
with the gutter landscape

**Meuse Bridge**  
An invisible bridge hidden into the steps  
and water

**Cultural Youth**  
Created in the site's garden topography  
of stone

@A4



**Observatorium**  
A simple, geometric, mobile with the sun  
hang through the openings on the building  
and response

**Meuse Bridge**  
Offers a new way to deal with the water  
at their height, emphasizing the body's  
social relationship to the ground plane

**Cultural Youth**  
The vertical order control the edge of the  
inclusion to honor our view of the air

@A3

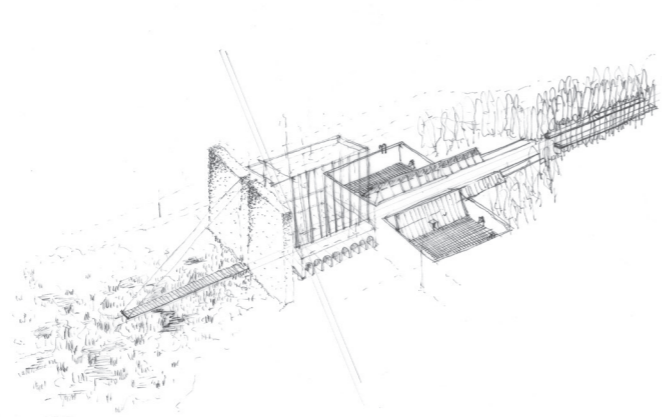

**Meuse Bridge** RGSAD Architects  
Fort De Roovere, Halbeuren, the Netherlands

@A3

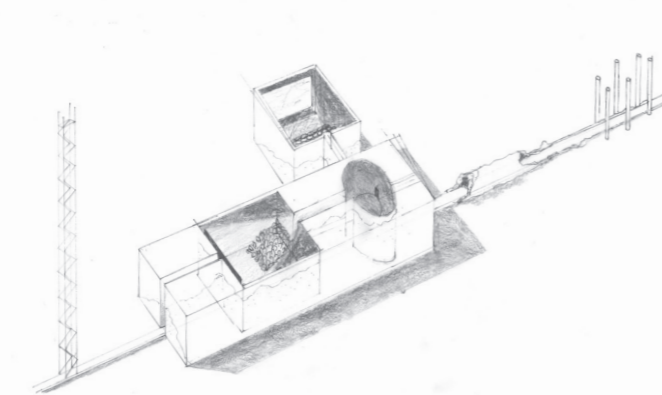

**Meuse Bridge** RGSAD Architects  
Fort De Roovere, Halbeuren, the Netherlands

@A3

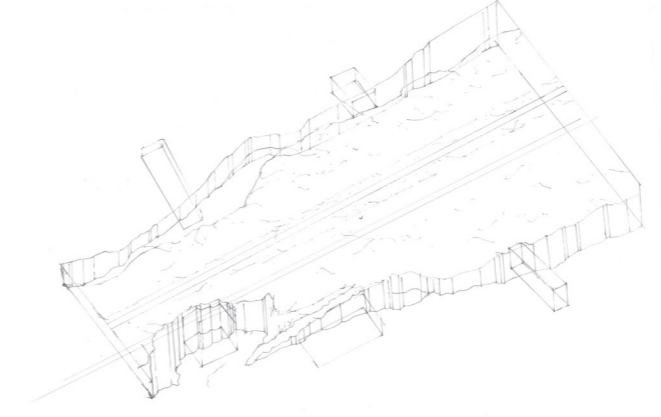

**Meuse Bridge** RGSAD Architects  
Fort De Roovere, Halbeuren, the Netherlands

@A3

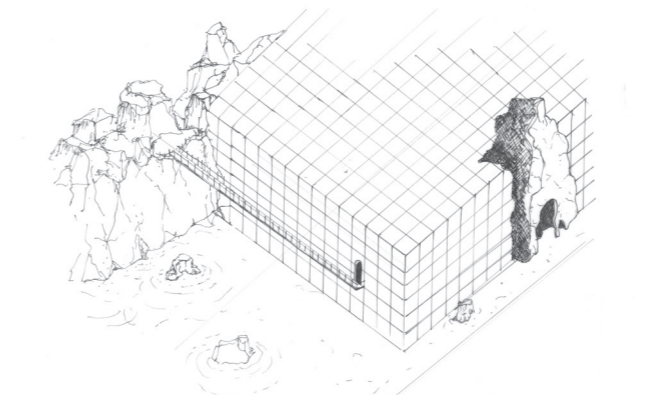

**Meuse Bridge** RGSAD Architects  
Fort De Roovere, Halbeuren, the Netherlands

@A4

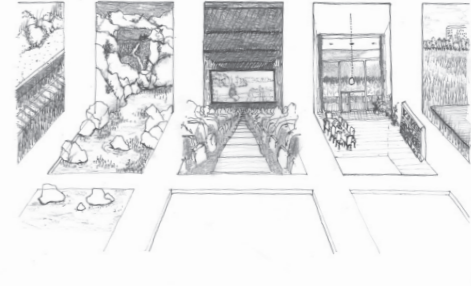

**Meuse Bridge** RGSAD Architects  
Fort De Roovere, Halbeuren, the Netherlands

@A4

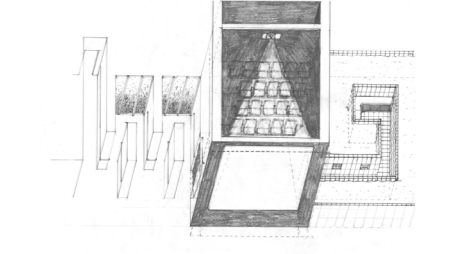

**Meuse Bridge** RGSAD Architects  
Fort De Roovere, Halbeuren, the Netherlands

@A4

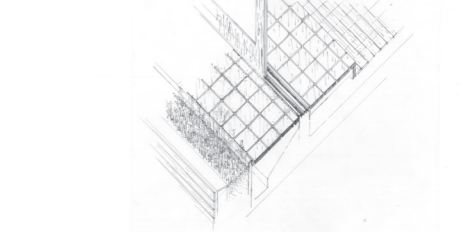

**Meuse Bridge** RGSAD Architects  
Fort De Roovere, Halbeuren, the Netherlands